

DOCUMENTS on DEPOSIT



ASHFORD
BOROUGH COUNCIL

**These documents
should remain available
for public inspection until
12 midday on 21 March
2025**

In the Borough of Ashford

**THE ASHFORD BOROUGH COUNCIL
HOUSING CAR PARK PLACES (PROHIBITION OF PARKING)
ORDER 2025**

Road Traffic Regulation Act 1984

Please return to:

Parking Services

Ashford Borough Council
International House
Dover Place
Ashford
TN23 1HU

**THE ASHFORD BOROUGH COUNCIL
HOUSING CAR PARK PLACES (PROHIBITION OF PARKING)
ORDER 2025**

Ashford Borough Council (the Council”) in exercise of its powers under sections 32, 33, 35, 124 and Part IV of Schedule 9 of the Road Traffic Regulations Act 1984 (“the 1984 act”) and section 43 and schedule 3 of the Road Traffic Act (“the 1991 Act”) Part 6 of the Traffic Management Act 2004 (“the 2004 Act”) and of all other powers enabling it in that behalf and with the consent of the Kent County Council given under section 30(3) of the 1984 Act and after consultation with the Chief Officer of Police in accordance with Part III of schedule 9 to the 1984 Act hereby propose to make the following Order:-

Commencement and Citation

1 (1) This order shall come into operation on the day of 2025 and may be cited as The Ashford Borough Council Housing Car Park Places (Prohibition of Parking) Order 2025, hereinafter referred to as “this Order”.

(2) The Ashford Borough Housing Car Parks Plans (“the Car Parks”) and the schedules of this order are incorporated into this Order.

Revocations

2 The orders listed within Schedule 1 are hereby revoked.

Interpretation

3 (1) In this Order the following expressions have the meanings assigned to them except where the context requires otherwise:

“the 1984 Act”	means the Road Traffic Regulation Act 1984
“the 1991 Act”	means the Road Traffic Act 1991
“the 2004 Act”	means the Traffic Management Act 2004
“Active Vehicle”	means the Vehicle which is selected to be valid on the users’ Permit Account.
“Camper Van”	has the same meaning as “Motor Caravan” (see below)
“Civil Enforcement Officer”	means a person authorised by or on behalf of the Council to supervise Parking Places and enforce the provisions of this Order and as is defined by Section 76(a) of the 2004 Act
“Coach”	has the same meaning as that which is set out in Regulation 3(2) of the Road Vehicles (Construction and Use) Regulations 1986 S.I. 1078
“the Council”	means Ashford Borough Council

“Disabled person’s Badge”	has the same meaning as that which is set out in Regulation 3(1) of the Local Authorities’ Traffic Orders (Exemptions for Disabled Persons) (England) Regulations 2000 S.I 683
“Driver”	in relation to a Vehicle in a Parking Place means the person driving or having control or charge of the said Vehicle, or the person having driven or having had control or charge of the Vehicle that entered or was left in the Parking Place
“Electric Vehicle”	means a motor Vehicle which is propelled by electric energy (battery-only powered Vehicle) from rechargeable batteries, inclusive of hybrid Vehicles, that combine an internal combustion engine with one or more electric motors powered by rechargeable batteries which require charging.
“Goods Vehicle”	means a motor Vehicle constructed or adapted for use for the carriage of goods or burden of any description
“Invalid Carriage”	has the same meaning as that set out in Section 136(5) of the 1984 Act
“Licensed Taxi”	means a Vehicle licensed as a hackney carriage under section 38 of the Town Police Clauses Act 1847, as amended
“Limited Waiting Bay”	means a Parking Bay designated for a period of free parking with a maximum time limit identified by signs and/or surface markings
“Loading or Unloading”	means the act of taking heavy or bulky goods from a Vehicle to a stationary premises.
“Minibus”	has the same meaning as that which is set out in Regulation 3(2) of the Road Vehicles (Construction and Use) Regulations 1986
“Motor Caravan”	has the same meaning as a Special Purpose Vehicle (Code ‘SA’) which is set out in Section 5.1 or EU Commission Regulation No 678/2011, as amended
“Motor Cycle”	has the same meaning as that which is set out in section 3 of the Road Vehicles (Construction and Use) Regulations 1986
“Off-Street Plans”	means the Ashford Borough Off-Street Plans which are incorporated into this Order pursuant to the Article 1(2) hereof
“Owner”	has the meaning assigned to it by Section 92(1) of the Traffic Management Act 2004
“Parking Bay”	means an area in a Parking Place delineated by white, yellow, green (or otherwise) markings to indicate the position

	in which a Vehicle shall be parked in that parking bay.
“Parking Charge”	means an amount ascertained by reference to the scales specified in Column 8 of Schedule 2 (or such other amount as shall be notified in accordance with Section 35c(1) of the 1984 Act) which has been paid at; a Ticket machine, or to a Civil Enforcement Officer, or by using the Council’s “pay by phone” arrangements or as otherwise deemed appropriate by the Council under the provisions of this Order in respect of a Vehicle left in that Parking Place for a parking period
“Parking Disc”	has the same meaning as that which is set out in Regulation 8(5) of the Local Authorities’ Traffic Orders (Exemptions for Disabled Persons) (England) Regulations 2000 S.I. 683
“Parking Period”	means a period of time within the chargeable hours set out in Column 5 of Schedule 2 for which a Parking Charge has been paid
“Parking Place”	has the same meaning as that set out in Section 32(4)(b) of the 1984 Act and is as stipulated in Column 1 of Schedule 2 and on the relevant Off-Street Plan
“Parking Ticket”	means a ticket issued in accordance with Article 7(1) identifying a specific Parking Place, date and time of expiry of the Parking Period
“Pay and display”	means a system of payment of a parking charge for the parking of motor Vehicles used at car parks where pre-paid tickets must be obtained and be displayed in the appropriate manner within the Vehicle for the entire period that the Vehicle is parked unless payment for parking has been made by “pay by phone”
“Pay by phone”	means a method of payment for a parking period whereby a parking charge (and any appropriate administration charge) is collected by a Borough Council appointed third party, via an arranged account with payment being made over the telephone or by other electronic system (including via the internet) by credit or debit card or other means of secure authorised payment
“Pay to park”	is to be construed in like fashion to “Pay and Display”
“Penalty Charge”	means a charge set in accordance with the provisions of the 1991 Act payable to the council following the issue of a penalty charge notice
“Permit”	means a non-transferable digital document issued by the

	council in accordance with Article 10 which when used in accordance with the particulars stipulated thereon provides authority for the specified Vehicle to remain in a specified Parking Place(s) without payment of the Parking Charge
“Permit Account”	means an account used to purchase Season Tickets, add & remove Vehicles and change the Active Vehicle, which is accessible by www.ashford.gov.uk
“Public Highway”	A public road maintained by the highway authority Kent County Council
“Relevant Position”	means; in the case of a Parking Ticket – a Vehicle displays a Parking Ticket in the Relevant Position if the said ticket is exhibited in a conspicuous position within the said Vehicle so that the side of the ticket marked “THIS SIDE UP” is clearly visible and can be read from the outside of the Vehicle; In the case if a Disabled Person’s Badge and a Parking Disc – A vehicle displayed a Disabled Persons’ Badge and a Parking Disc in the Relevant Position if the badge or disc if displayed in accordance with Regulation 4 of the Local Authorities’ Traffic Orders (Exemptions for Disabled Persons) (England) Regulations 2000 S.I. 683
“Season Ticket”	means a non-transferable season ticket issued by the Council in accordance with Article 9 which when the Vehicle is marked active via the users’ Permit Account shall permit the Vehicle specified on the said season ticket to park without displaying a valid parking ticket
“Taxi”	has the same meaning as “licensed taxi” (see above)
“Ticket Machine”	means an apparatus installed in a parking place to issue a Parking Ticket
“Vehicle”	has the same meaning as that assigned to “motor Vehicle” in section 136(1) of the 1984 Act

- 3** (2) Except where the context otherwise requires, references in this Order to Articles and Schedules are references to the Articles of and Schedules to this Order.
- 3** (3) The interpretation Act 1978 shall apply for the interpretation of this Order as it applies for the interpretation of an Act of Parliament.
- 3** (4) Any reference in this Order to any enactment, shall be construed as a reference to that enactment as amended by any subsequent enactment.

Parking Places

4 Each of the Parking Places specified in Column 1 of Schedule 2 and as identified and defined in the Car Parks may only be used, subject to the provisions of this Order, for the parking of such classes of Vehicles in such positions, on such days and during such hours as are specified in Columns 2 to 5 respectively of Schedule 2 in relation to that Parking Place.

Class, Position, and Parking Charges

5 (1) A vehicle shall not enter or remain in a Parking Place unless the said Vehicle falls within a class specified in Column 2 of Schedule 2 in relation to that Parking Place.

5 (2) A vehicle shall not enter or remain in a Parking Bay reserved by means of a sign or surface marking for use by Vehicles of a class specified in column 2 of schedule 2 unless the said Vehicle is of the class for the said Parking Bay is so reserved.

5 (3) A vehicle shall be wholly parked within the limits of a Parking Bay indicated in Column 3 of Schedule 2 in relation to the Parking Place in which that Parking Bay is situated.

5 (4) Save as provided for in Article 7(4), the driver of a Vehicle on causing that Vehicle to remain in a Parking Place at any time during the chargeable hours specified in column 5 of Schedule 2 in relation to the Parking Place in which that Vehicle is parked shall display a valid Permit.

Maximum Period for which a Vehicle may remain in a Parking Place and Restrictions on Return Periods

6 (1) Except with the permission of the Council, no Vehicle shall remain in a Parking Place for longer than the maximum period stipulated in Column 6 of Schedule 2 in relation to that Parking Place.

6 (2) No vehicle that has been caused to remain in a Parking Bay shall (except with the permission of the Council) remain in that Parking Bay save in accordance with that which is stipulated by any sign or surface marking in relation to that Parking Bay.

6 (3) No Vehicle that has been caused to remain in a Parking Bay shall (except with the permission of the Council) be returned to any Parking Bay within the same Parking Place, before the expiry of any period of time stipulated in Column 7 of Schedule 2 in relation to that Parking Place or as is stipulated by any sign or surface marking in relation to that Parking Bay.

6 (4) Except with the permission of the Council, no Electric Vehicle shall remain in an Electric Vehicle Parking Bay for longer than the maximum period stipulated by the signage in relation to that Parking Bay.

Use of Parking Places

7 (1) Save as provided for in Article 7(4), no Vehicle shall remain in a Parking Place unless it displays in the Relevant Position at all times while it remains in that Parking Place a Permit that is valid for the Vehicle.

7 (2) Save as provided for in Article 7(4), no Vehicle shall remain in a Parking Place after the expiry date of a Permit.

7 (3) A vehicle shall not remain in a Parking Place or part thereof that has been reserved by means of a sign or surface marking for use by:

Permit holder Vehicles

(a) specific Permit holders holding a valid Permit for the said Parking Place or part thereof unless the said Vehicle displays a valid permit for that Parking Place or part thereof in accordance with Article 7(4)(c);

Disabled Person's Badge holders

(b) Disabled Person's Badge holders unless the said Vehicle displays a valid disabled persons badge in accordance with Article 7(4)(c);

Loading and Unloading

(c) Vehicles in connection with loading and unloading unless the said Vehicle is being loaded and/or unloaded in accordance with Article 7(4)(f);

Electric Vehicles

(d) Electric Vehicles unless the said Vehicle is of the class for which that Parking Place or part thereof is so reserved and an active charge session is taking place.

7 (4) The following exemptions apply in relation to Articles 5(4), 7(1) and 7(2) in the specified circumstances:

(a) A Vehicle at all times while it remains in a Parking Place a valid season ticket in the Relevant Position, issued in accordance with Article 9 for the specified Parking Place(s) for which the Season Ticket was issued and in which the said Vehicle is situated;

(b) A vehicle displaying at all times while it remains in a Parking Place a valid Disabled Person's Badge;

(c) A Vehicle displaying at all times while it remains in a Parking Place a valid permit issued in accordance with Article 10 in the Relevant Position and complying with the particulars stipulated thereon;

(d) A Motor Cycle parked in a Parking Bay identified by signs and/or surface marking as provided for use of Motor Cycles only';

- (e) A vehicle parked in an area identified by signs and/or surface marking as provided in connection with the depositing of appropriate items in recycling receptacles position in a Parking Place for so long as is reasonably required to deposit the same items;
- (f) A Vehicle parked in a Parking Bay identified by signs and/or surface markings as provided for use that in connection with loading and/or unloading provided that goods are being continually loaded onto the Vehicle or unloaded from the Vehicle and that does not remain longer than the period stipulated on any nearby sign relation to that Parking Bay;
- (g) A Vehicle parked in a Limited Waiting Bay identified by signs and/or surface markings that allow a period of free parking;
- (h) A Vehicle parked for the purpose of undertaking repairs at a property which is eligible for a permit, with the Council's prior agreement.

7 (5) For the purposes of this Article a Vehicle shall be deemed to remain in a Parking Place if it departs from and returns to that Parking Place within one hour.

7 (6) No Vehicle shall remain on double yellow lines in a Parking Place, including utilising common exemptions found on double yellow lines on the Public Highway. The exemption for Loading or Unloading and Disabled person's Badge used on the Public Highway are not used in any Parking Place without prior agreement from the Council.

Closure or Suspension of use of a Parking Place

8 (1) Notwithstanding any of the provisions of this Order the Council may by notice displayed on or near a Parking Place close or suspend that Parking Place or any part thereof for any period and may use such Parking Place or any part thereof for any purpose.

8 (2) No vehicle shall enter or remain in a Parking Place or any part thereof that has been closed or suspended as described in paragraph (1) of this Article without the prior consent in writing of the Council.

8 (3) No Vehicle shall enter or remain in a Parking Place outside the day of operation specified in Column 4 of Schedule 2 in relation to that Parking Place.

8 (4) No Vehicle shall enter or remain in a Parking Place outside the days of operation specified in Column 5 of Schedule 2 in relation to that Parking Place
Season Tickets

9 (1) The Council may at its discretion issue season tickets for use in Parking Places which shall permit the Vehicle specified on the Season Ticket to park without

payment of the Parking Charge. Where applicable, the charge for such season ticket is as stipulated in Column 8 of Schedule 2 in relation to that Parking Place (or such other amount as shall be notified in accordance with Section 35C(1) of the 1984 Act) and shall be payable in advance.

9 (2) A season ticket may be used only in respect of the Active Vehicle.

9 (3) A Vehicle is not parked in accordance with this Article unless the Vehicle on the Season Ticket is made the Active Vehicle on the Permit Account.

Permits

10 (1) The Council may at its discretion issue permits which shall permit Vehicle(s) to park in a Parking Place without a valid parking session.

10 (2) A Permit may be used only in respect of the Vehicle or Vehicles for which it is issued.

10 (3) No person shall use a Permit otherwise than in accordance with this Order, any other conditions set out on the Permit or any conditions set out in an application form in respect of the said Permit.

10 (4) Any Permit issued by the Council remains the property of the Council and is not transferable to another Vehicle or Parking Place.

10 (5) A Permit listed in Schedule 3 (column 1) may be activated by residents residing in properties in Schedule 3 (column 2) and the Permit will be valid in locations listed in Schedule 3 (column 3).

Penalty Charge

11 If a Vehicle remains in a Parking Place in contravention of any Article contained within this Order, a Penalty Charge will be payable by the owner of that Vehicle.

Other Provisions

12 The Driver of a Vehicle using a Parking Place shall stop the engine as soon as the said Vehicle is in position in the Parking Place and shall not start the engine except when about to change the position of the Vehicle or to depart from that Parking Place.

13 A Vehicle shall not cause an obstruction in a Parking Place.

14 A Vehicle may only use a Disabled Person's Badge in a Parking Place, where the Vehicle is parked in accordance with Article 7(4)(b).

15 (1) No person shall use a Vehicle while it is in a Parking Place in connection with the sale of any article to persons in or near that Parking Place or in connection with the selling or offering for hire of his skill or service.

15 (2) No person shall leave any Vehicle in a Parking Place in connection with the sale or advertising or displaying for sale of that or any other Vehicle.

15 (3) No person shall use any part of a Parking Place or any Vehicle left in a Parking Place:

(a) For sleeping or camping or cooking;

(b) For the purpose of servicing or washing any Vehicle or part thereof other than is reasonably necessary to enable that the Vehicle to depart from that Parking Place.

16 No person shall in a Parking Place wantonly shout or otherwise make any loud noise to the disturbance or annoyance of users of the Parking Place or residents of premises in the neighbourhood.

17 No person shall in a Parking Place use any threatening, abusive, or insulting language, gesture or conduct with intent to put any person in fear or so as to

occasion a breach of the peace or whereby a breach of the peace is likely to be occasioned.

18 In a Parking Place, no person shall:

- (a) Erect or cause to be erected any tent, booth, stand, building or other structure without the written consent of the Council;
- (b) Light or cause or permit to be lit any fire.

19 The driver of a Vehicle shall not use a Parking Place as a means of passage proceeding from one road to another.

20 The driver of a Vehicle using a Parking Place shall not sound any audible warning instrument save in circumstances where such action is reasonably required.

21 (1) If a Vehicle is left in a Parking Place other than in accordance with the provisions of this Order a person authorised by the Council in that behalf may alter or cause to be altered the position of that Vehicle so that its position is in accordance with said provisions.

21 (2) If a Vehicle is left in a Parking Place in contravention of any of the foregoing provisions of this Order a person authorised by the Council in that behalf may remove the said Vehicle from that Parking Place or arrange for such removal.

21 (3) For the purpose of meeting the requirement of an emergency a person authorised in that behalf by the Council or a police constable in uniform may alter or cause to be altered the position of a Vehicle from that Parking Place.

21 (4) Any person altering or causing the alteration of the position of a Vehicle by virtue of paragraph (1) of this Article or removing or causing the removal of a Vehicle by virtue of paragraphs (2) or (3) of this Article may do so by towing or driving the said Vehicle or in such other manner as he may think reasonable necessary to enable the position of the said Vehicle to be altered or the said Vehicle to be removed.

21 (5) Any person removing or arranging for the removal of a Vehicle by virtue of paragraph (2) or (3) of this Article shall make arrangements as he considers to be reasonably necessary for the safety of the said Vehicle in the place to which it is removed.

22 Where in a Parking Place signs are erected or surface markings are laid for the purpose of

- (a) indicating the entrance to or exit from the Parking Place; or
- (b) indicating that a Vehicle is using the Parking Place shall proceed in a specified direction with the Parking Place

no person shall drive or permit to be driven any Vehicle:

- (i) so that it enters the Parking Place otherwise than by an entrance or leave the Parking Place otherwise than by an exit so indicated; or
- (ii) in a direction other than so specified

23 No person shall except with the permission of a person authorised by the Council in that behalf drive or permit to be driven any Vehicle in a Parking Place for any purpose other than the purpose of leaving that Vehicle in the Parking Place in accordance with the provisions of this Order or for the purpose of departing from the Parking Place.

24 No person shall in any Parking Place without the consent of the Council distribute or affix to any Vehicle left in that Parking Place any literature or leaflets.

GIVEN under the COMMON SEAL of)
the ASHFORD BOROUGH COUNCIL)
Which was hereunto affixed this day) _____

Mayor

Solicitor

SCHEDULE 1

The list of Traffic Orders revoked by this order:

No previous Traffic Orders are to be revoked in this order.

SCHEDULE 2

1 Name of Parking Place	2 Classes of Vehicle	3 Position in which Vehicles may park	4 Days of operation of Parking Place	5 Chargeable hours and hours of operation	6 Maximum period for which Vehicles may remain	7 Restrictions on periods of return	8 Parking period and scale of Parking Charges for eligible properties (Schedule 3)
1. Alfred Road Car Park A	Motor vehicles not exceeding 3.5 tonnes maximum gross weight	Parked wholly within a bay	All days Including bank holidays	Chargeable Hours 24 hours Hours of Operations 24 hours	No limit	No restrictions on return period	1x Digital permit (12 month) £0 for eligible properties 1x Digital Visitor Permit (12 month) £0 for eligible properties
2. Alfred Road Car Park B	Motor vehicles not exceeding 3.5 tonnes maximum gross weight	Parked wholly within a bay	All days Including bank holidays	Chargeable Hours 24 hours Hours of Operations 24 hours	No limit	No restrictions on return period	1x Digital permit (12 month) £0 for eligible properties 1x Digital Visitor Permit (12 month) £0 for eligible properties
3. Alfred Road Car Park C	Motor vehicles not exceeding 3.5 tonnes maximum gross weight	Parked wholly within a bay	All days Including bank holidays	Chargeable Hours 24 hours Hours of Operations 24 hours	No limit	No restrictions on return period	1x Digital permit (12 month) £0 for eligible properties 1x Digital Visitor Permit (12 month) £0 for eligible properties
4. Beaver Lane Car Park	Motor vehicles not exceeding 3.5 tonnes maximum gross weight	Parked wholly within a bay	All days Including bank holidays	Chargeable Hours 24 hours Hours of Operations 24 hours	No limit	No restrictions on return period	1x Digital permit (12 month) £0 for eligible properties 1x Digital Visitor Permit (12 month) £0 for eligible properties
5. Belmont Place Car Park	Motor vehicles not exceeding 3.5 tonnes maximum gross	Parked wholly within a bay	All days Including bank	Chargeable Hours 24 hours	No limit	No restrictions on return period	1x Digital permit (12 month) £0 for eligible properties 1x Digital Visitor Permit (12

	weight		holidays	Hours of Operations 24 hours			month) £0 for eligible properties
6. Berry Place Car Park	Motor vehicles not exceeding 3.5 tonnes maximum gross weight	Parked wholly within a bay	All days Including bank holidays	Chargeable Hours 24 hours Hours of Operations 24 hours	No limit	No restrictions on return period	1x Digital permit (12 month) £0 for eligible properties 1x Digital Visitor Permit (12 month) £0 for eligible properties
7. Bulleid Place Car Park	Motor vehicles not exceeding 3.5 tonnes maximum gross weight	Parked wholly within a bay	All days Including bank holidays	Chargeable Hours 24 hours Hours of Operations 24 hours	No limit	No restrictions on return period	1x Digital permit (12 month) £0 for eligible properties 1x Digital Visitor Permit (12 month) £0 for eligible properties
8. Crownfield Road Car Park	Motor vehicles not exceeding 3.5 tonnes maximum gross weight	Parked wholly within a bay	All days Including bank holidays	Chargeable Hours 24 hours Hours of Operations 24 hours	No limit	No restrictions on return period	1x Digital permit (12 month) £0 for eligible properties 1x Digital Visitor Permit (12 month) £0 for eligible properties
9. Danemore Car Park	Motor vehicles not exceeding 3.5 tonnes maximum gross weight	Parked wholly within a bay	All days Including bank holidays	Chargeable Hours 24 hours Hours of Operations 24 hours	No limit	No restrictions on return period	1x Digital permit (12 month) £0 for eligible properties 1x Digital Visitor Permit (12 month) £0 for eligible properties
10. East Stour Court Car Park	Motor vehicles not exceeding 3.5 tonnes maximum gross weight	Parked wholly within a bay	All days Including bank holidays	Chargeable Hours 24 hours Hours of Operations 24 hours	No limit	No restrictions on return period	1x Digital permit (12 month) £0 for eligible properties 1x Digital Visitor Permit (12 month) £0 for eligible properties

11. Engineers Court Car Park	Motor vehicles not exceeding 3.5 tonnes maximum gross weight	Parked wholly within a bay	All days Including bank holidays	Chargeable Hours 24 hours Hours of Operations 24 hours	No limit	No restrictions on return period	1x Digital permit (12 month) £0 for eligible properties 1x Digital Visitor Permit (12 month) £0 for eligible properties
12. Fortis House Car Park	Motor vehicles not exceeding 3.5 tonnes maximum gross weight	Parked wholly within a bay	All days Including bank holidays	Chargeable Hours 24 hours Hours of Operations 24 hours	No limit	No restrictions on return period	1x Digital permit (12 month) £0 for eligible properties 1x Digital Visitor Permit (12 month) £0 for eligible properties
13. Forrester's Place Car Park	Motor vehicles not exceeding 3.5 tonnes maximum gross weight	Parked wholly within a bay	All days Including bank holidays	Chargeable Hours 24 hours Hours of Operations 24 hours	No limit	No restrictions on return period	1x Digital permit (12 month) £0 for eligible properties 1x Digital Visitor Permit (12 month) £0 for eligible properties
14. Longfield Car Park	Motor vehicles not exceeding 3.5 tonnes maximum gross weight	Parked wholly within a bay	All days Including bank holidays	Chargeable Hours 24 hours Hours of Operations 24 hours	No limit	No restrictions on return period	1x Digital permit (12 month) £0 for eligible properties 1x Digital Visitor Permit (12 month) £0 for eligible properties
15. Marlowe Road Car Park	Motor vehicles not exceeding 3.5 tonnes maximum gross weight	Parked wholly within a bay	All days Including bank holidays	Chargeable Hours 24 hours Hours of Operations 24 hours	No limit	No restrictions on return period	1x Digital permit (12 month) £0 for eligible properties 1x Digital Visitor Permit (12 month) £0 for eligible properties
16. Maunsell Place Car Park	Motor vehicles not exceeding 3.5 tonnes	Parked wholly within a	All days Including	Chargeable Hours 24 hours	No limit	No restrictions on return	1x Digital permit (12 month) £0 for eligible properties

	maximum gross weight	bay	bank holidays	Hours of Operations 24 hours		period	1x Digital Visitor Permit (12 month) £0 for eligible properties
17. Newtown Green Car Park A	Motor vehicles not exceeding 3.5 tonnes maximum gross weight	Parked wholly within a bay	All days Including bank holidays	Chargeable Hours 24 hours Hours of Operations 24 hours	No limit	No restrictions on return period	1x Digital permit (12 month) £0 for eligible properties 1x Digital Visitor Permit (12 month) £0 for eligible properties
18. Newtown Green Car Park B	Motor vehicles not exceeding 3.5 tonnes maximum gross weight	Parked wholly within a bay	All days Including bank holidays	Chargeable Hours 24 hours Hours of Operations 24 hours	No limit	No restrictions on return period	1x Digital permit (12 month) £0 for eligible properties 1x Digital Visitor Permit (12 month) £0 for eligible properties
19. Norwood Gardens Car Park	Motor vehicles not exceeding 3.5 tonnes maximum gross weight	Parked wholly within a bay	All days Including bank holidays	Chargeable Hours 24 hours Hours of Operations 24 hours	No limit	No restrictions on return period	1x Digital permit (12 month) £0 for eligible properties 1x Digital Visitor Permit (12 month) £0 for eligible properties
20. Regents Court Car Park	Motor vehicles not exceeding 3.5 tonnes maximum gross weight	Parked wholly within a bay	All days Including bank holidays	Chargeable Hours 24 hours Hours of Operations 24 hours	No limit	No restrictions on return period	1x Digital permit (12 month) £0 for eligible properties 1x Digital Visitor Permit (12 month) £0 for eligible properties
21. Somerset Heights Car Park	Motor vehicles not exceeding 3.5 tonnes maximum gross weight	Parked wholly within a bay	All days Including bank holidays	Chargeable Hours 24 hours Hours of Operations 24 hours	No limit	No restrictions on return period	1x Digital permit (12 month) £0 for eligible properties 1x Digital Visitor Permit (12 month) £0 for eligible properties

				24 hours			
22. St Mildreds Close Car Park	Motor vehicles not exceeding 3.5 tonnes maximum gross weight	Parked wholly within a bay	All days Including bank holidays	Chargeable Hours 24 hours Hours of Operations 24 hours	No limit	No restrictions on return period	1x Digital permit (12 month) £0 for eligible properties 1x Digital Visitor Permit (12 month) £0 for eligible properties
23. Stour Heights Car Park	Motor vehicles not exceeding 3.5 tonnes maximum gross weight	Parked wholly within a bay	All days Including bank holidays	Chargeable Hours 24 hours Hours of Operations 24 hours	No limit	No restrictions on return period	1x Digital permit (12 month) £0 for eligible properties 1x Digital Visitor Permit (12 month) £0 for eligible properties
24. Wainwright Place Car Park	Motor vehicles not exceeding 3.5 tonnes maximum gross weight	Parked wholly within a bay	All days Including bank holidays	Chargeable Hours 24 hours Hours of Operations 24 hours	No limit	No restrictions on return period	1x Digital permit (12 month) £0 for eligible properties 1x Digital Visitor Permit (12 month) £0 for eligible properties

SCHEDULE 3

Column 1	Column 2	Column 3
Permit Identifier	Resident Addresses	Car Parks Eligible
X	Danemore (No's 13-46)	Danemore Car Park
	Longfield (No's 1-34)	Longfield Car Park
	St Mildreds Close (No's 1-15)	St Mildred's Close Car Park
Y	East Stour Court (No's 1-29)	Alfred Road Car Park A
	Forresters Place (No's 1-16)	Alfred Road Car Park B
	Maunsell Place (No's 6-43)	Alfred Road Car Park C
	Wainwright Place (No's 1-27)	Beaver Lane Car Park
	Berry Place (No's 1-31)	Belmont Place Car Park
	Crownfield Road (Odds No's 37-53)	Berry Place Car Park
	Alfred Road (No's 14-19)	Bulleid Place Car Park
	Belmont Place (No's 1-46)	Crownfield Road Car Park
	Bulleid Place (No's 1-28)	East Stour Court Car Park
	Newtown Green (No's 1-104)	Forresters Place Car Park
	Court Wurtin (Even No's 26-44)	Maunsell Place Car Park
	Court Wurtin (No's 45-58)	Newtown Green Car Park A
		Newtown Green Car Park B
	Wainwright Place Car Park	
Z	Engineers Court (No's 1-11)	Engineers Court Car Park
	Regents Court (No's 1-10)	Fortis House Car Park
	Marlowe Road (No's 1-14)	Marlowe Road Car Park
	Somerset Heights (No's 1-44)	Norwood Gardens Car Park
	Stour Heights (No's 1-65)	Regents Court Car Park
	Fortis House (No's 1-23)	Somerset Heights Car Park
	Kipling Road (No's 1-18)	Stour Heights Car Park
	Milton Road (No's 1-9)	
Milton Road (Annexe at No 12)		

	Norwood Gardens (No's 1-16)	
	Norwood Gardens (Even No's 18-26)	
	Forge Lane (Flat No's 102)	
	Forge Lane (Annex at No 33)	

**SCHEDULE 4
THE ASHFORD BOROUGH COUNCIL HOUSING CAR PARKS PLANS**

1. Alfred Road Car Park A



2. Alfred Road Car Park B

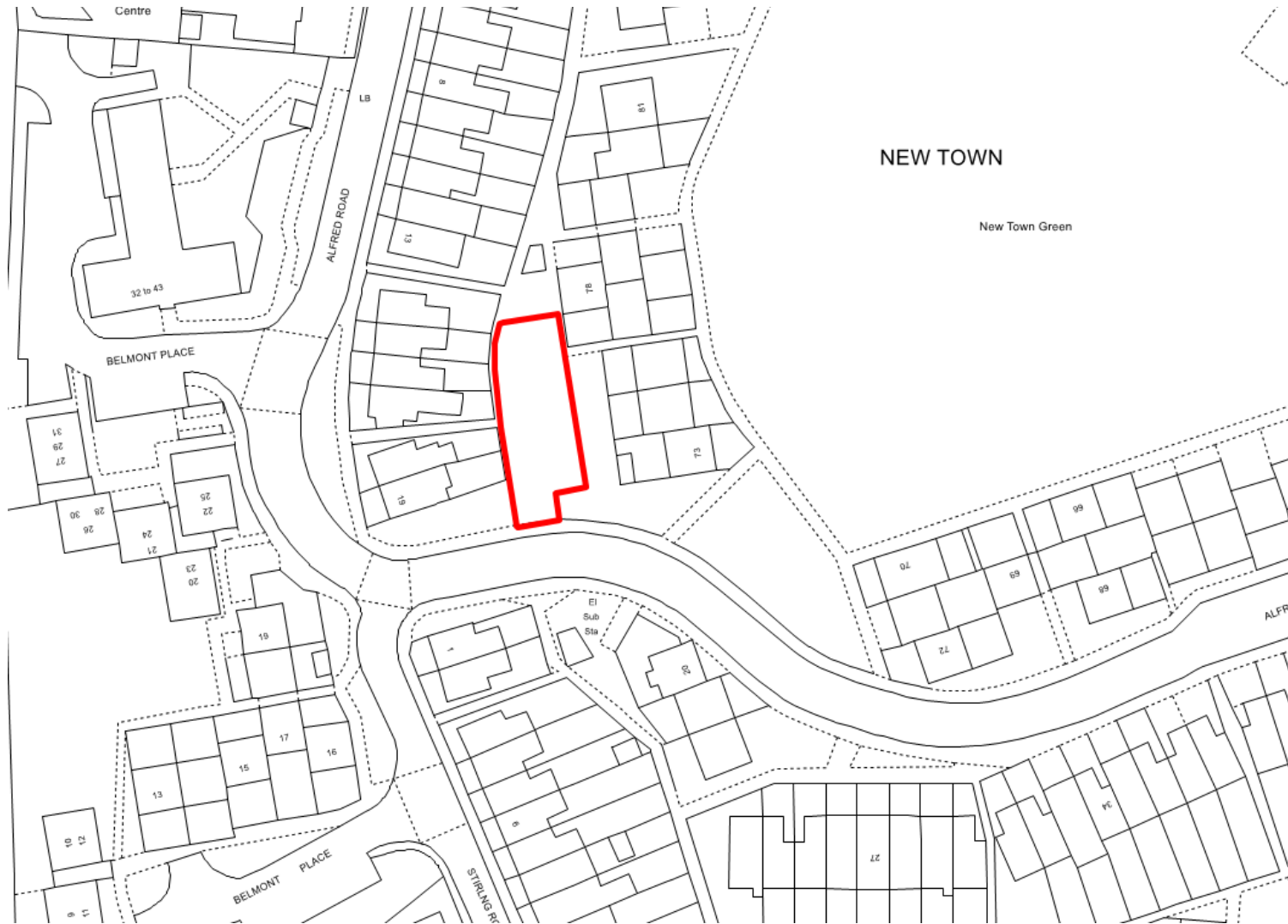

3. Alfred Road Car Park C



4. Beaver Lane Car Park

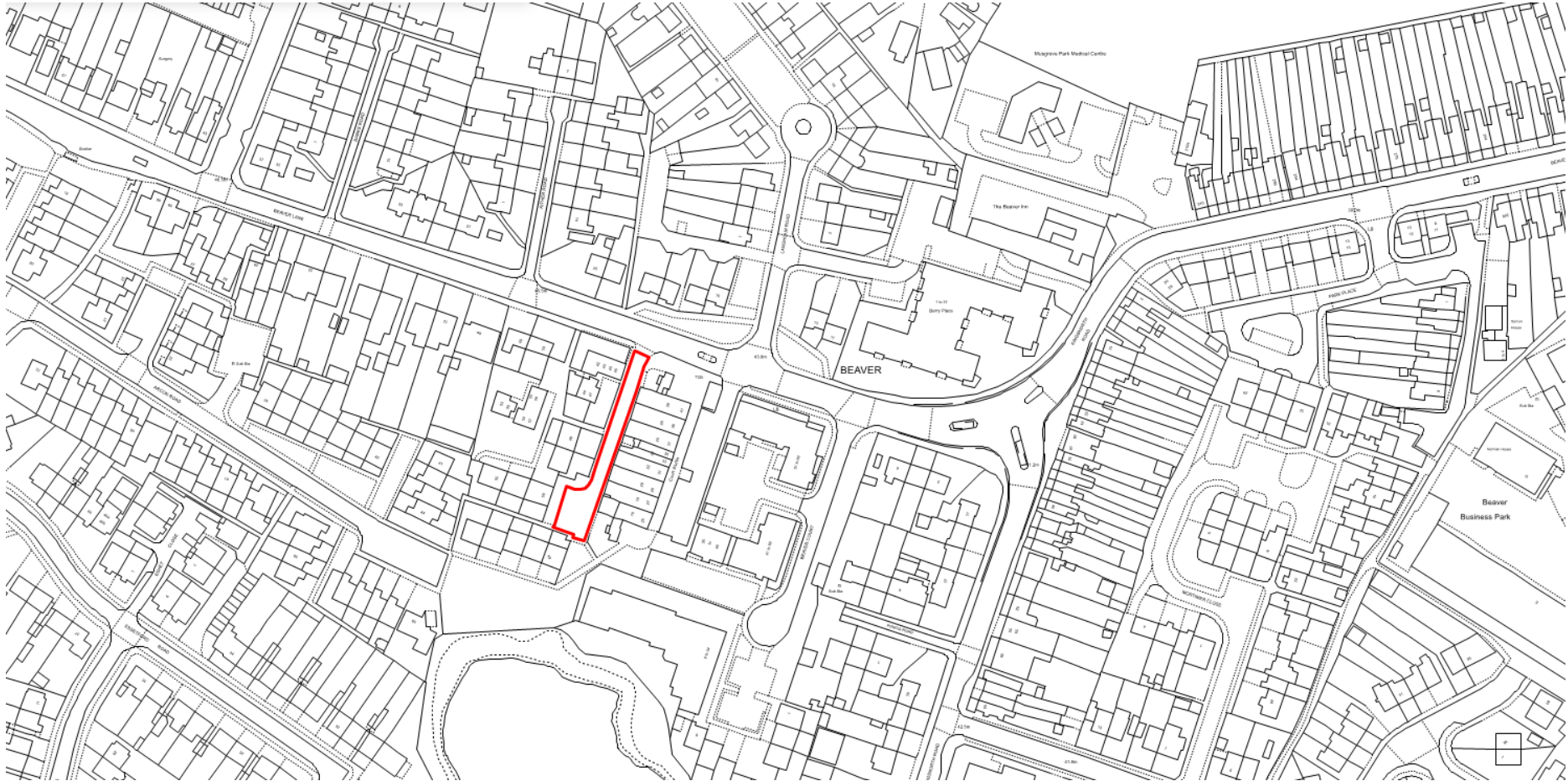

5. Belmont Place Car Park

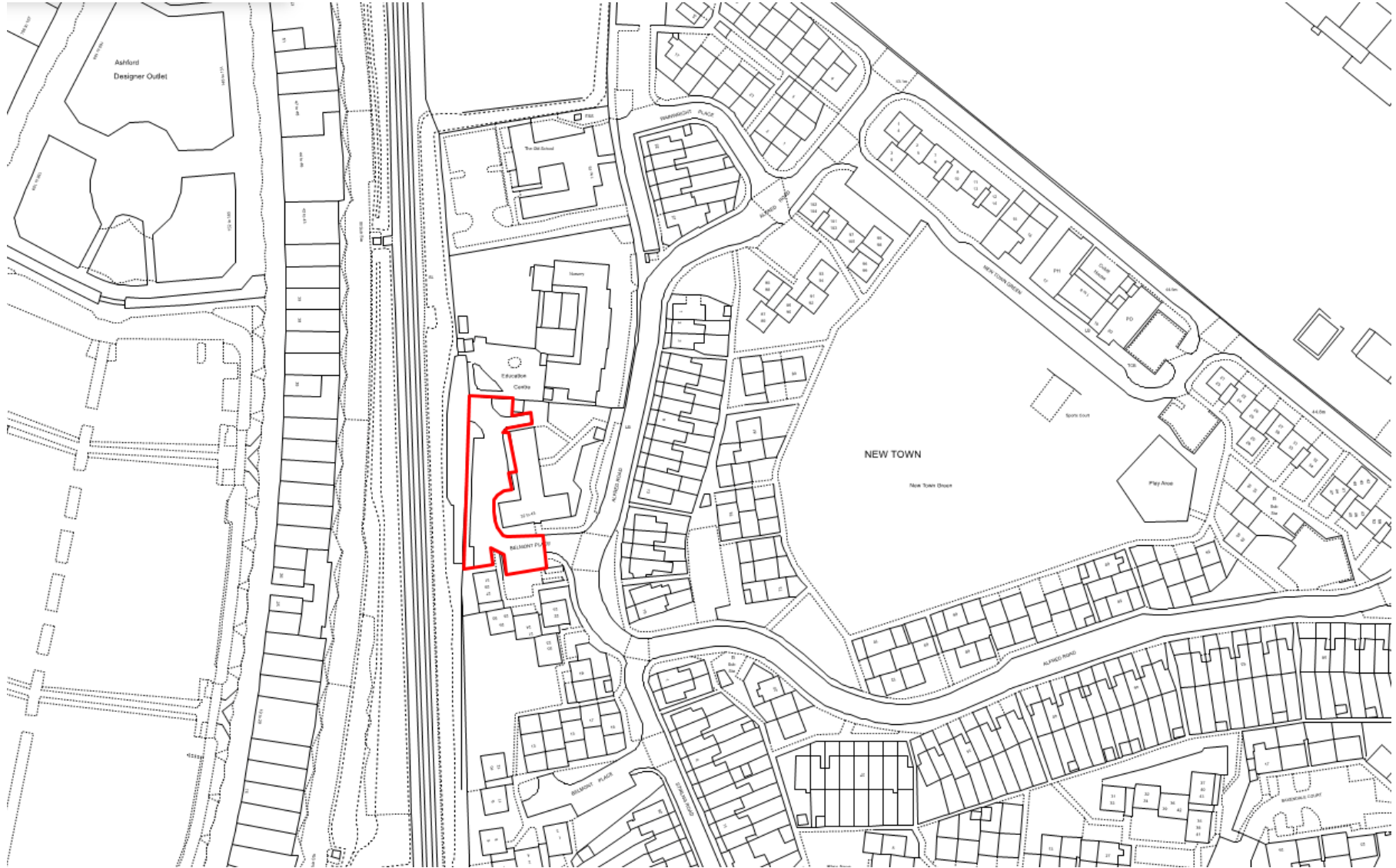

6. Berry Place Car Park

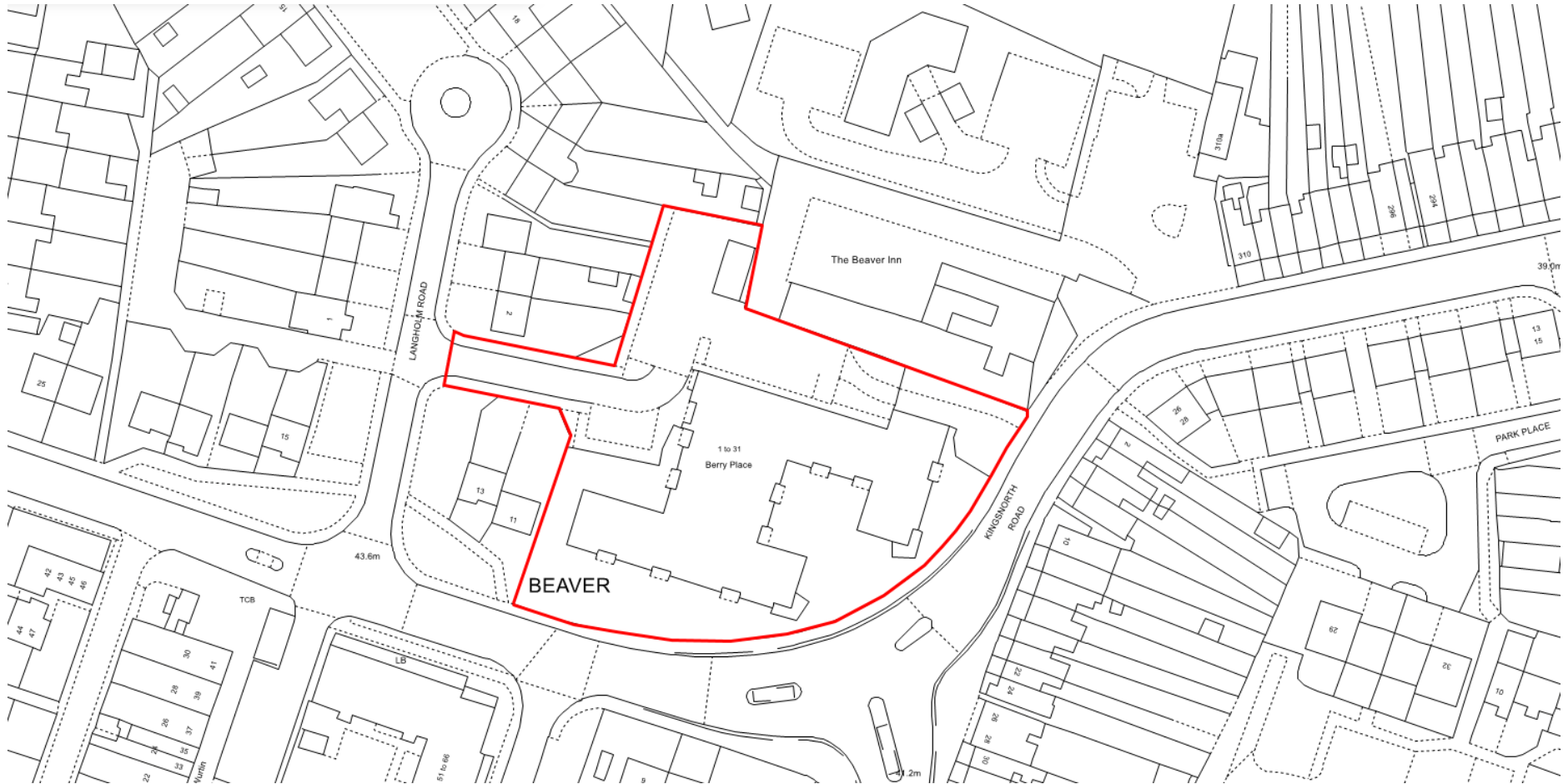

7. Bulleid Place Car Park

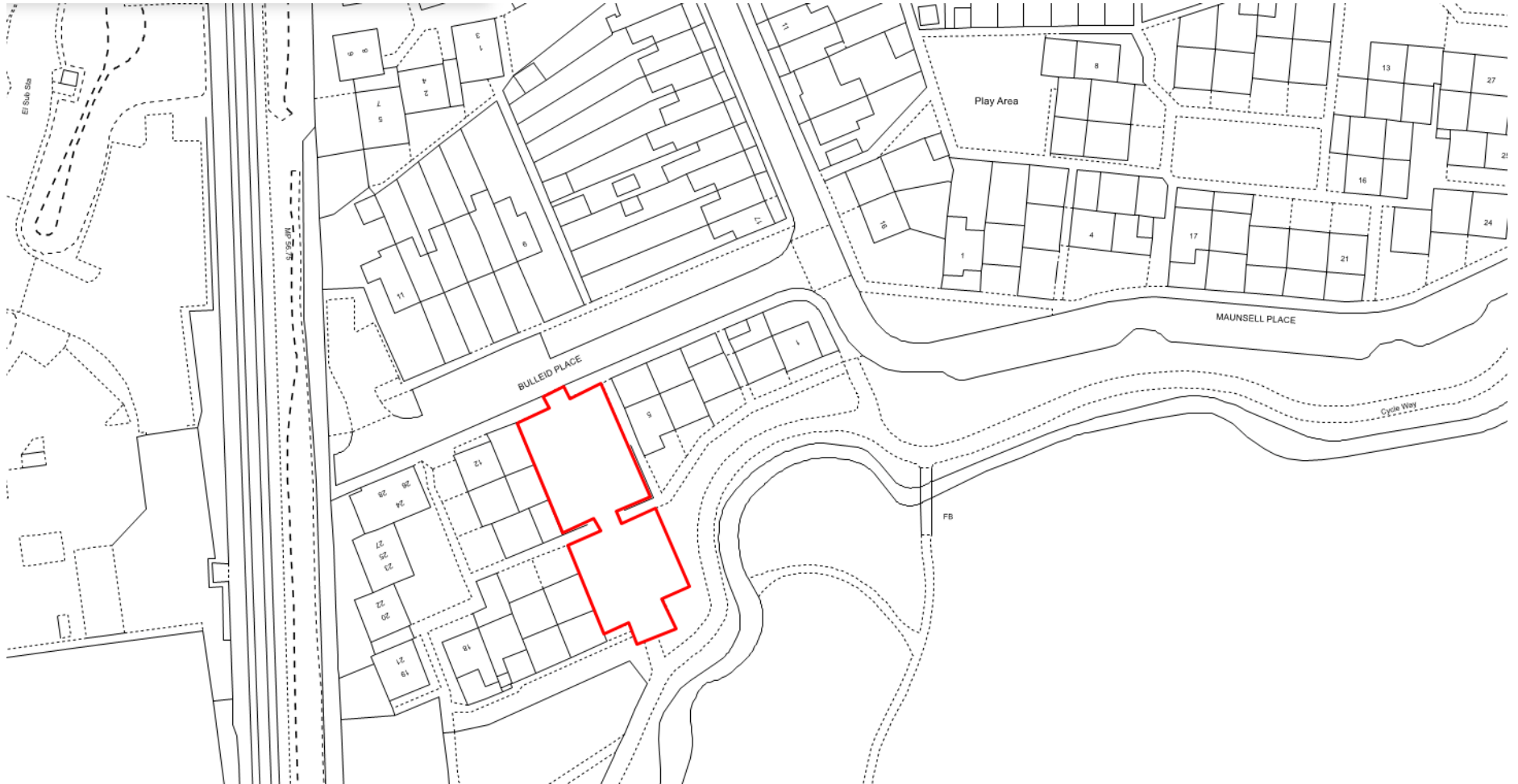

8. Crownfield Road Car Park

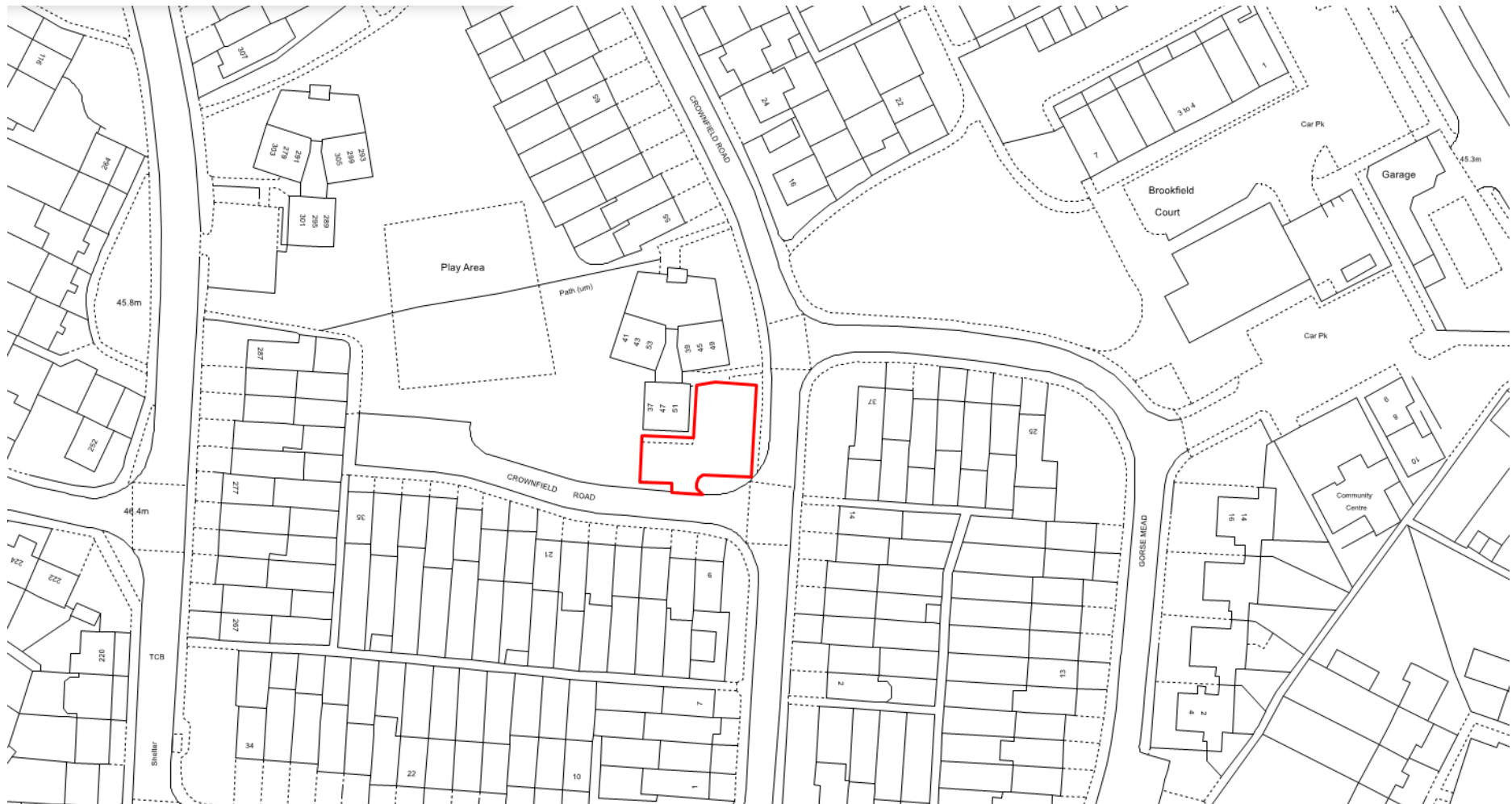

9. Danemore Car Park



10. East Stour Court Car Park

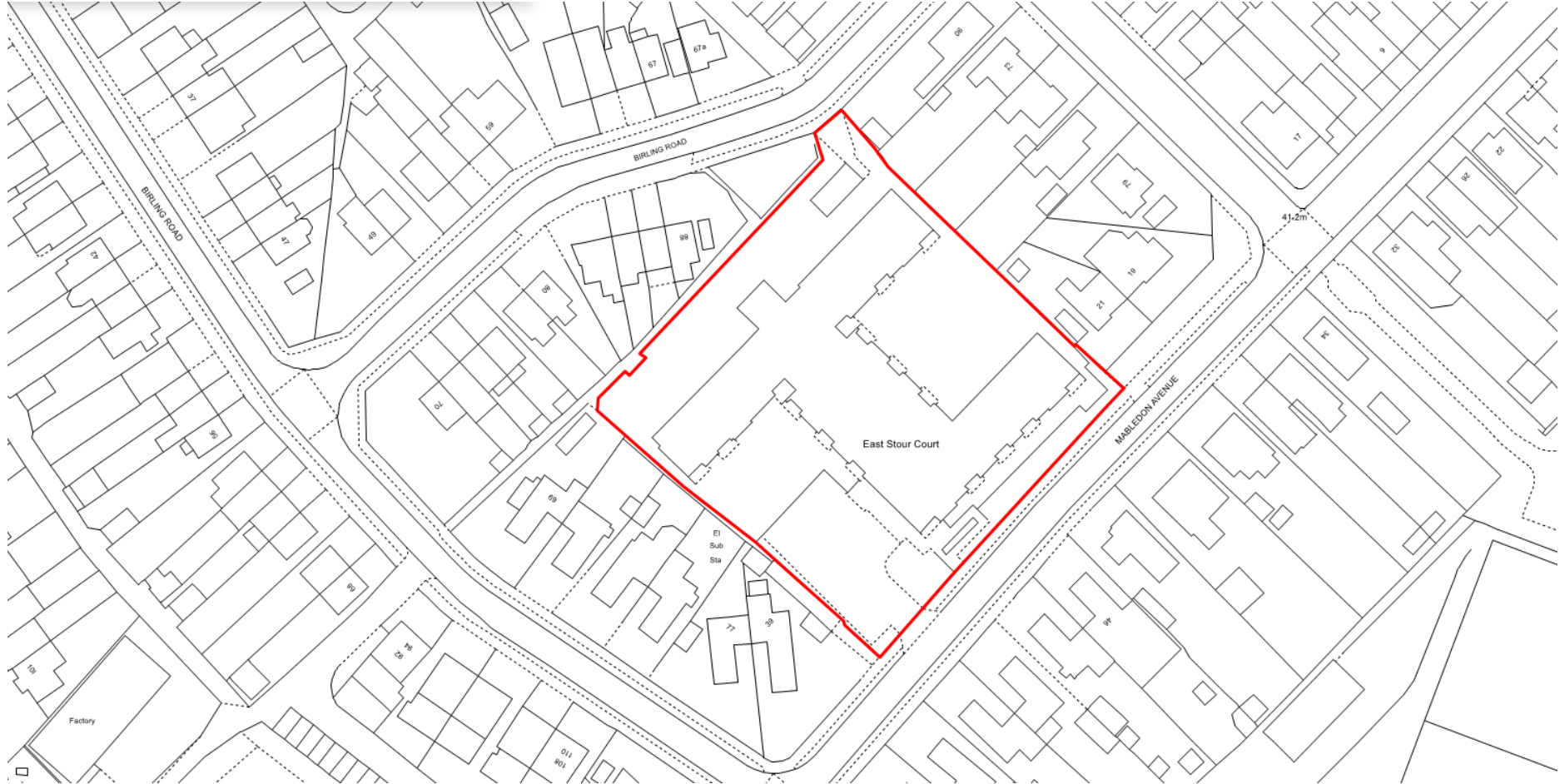

11. Engineers Court

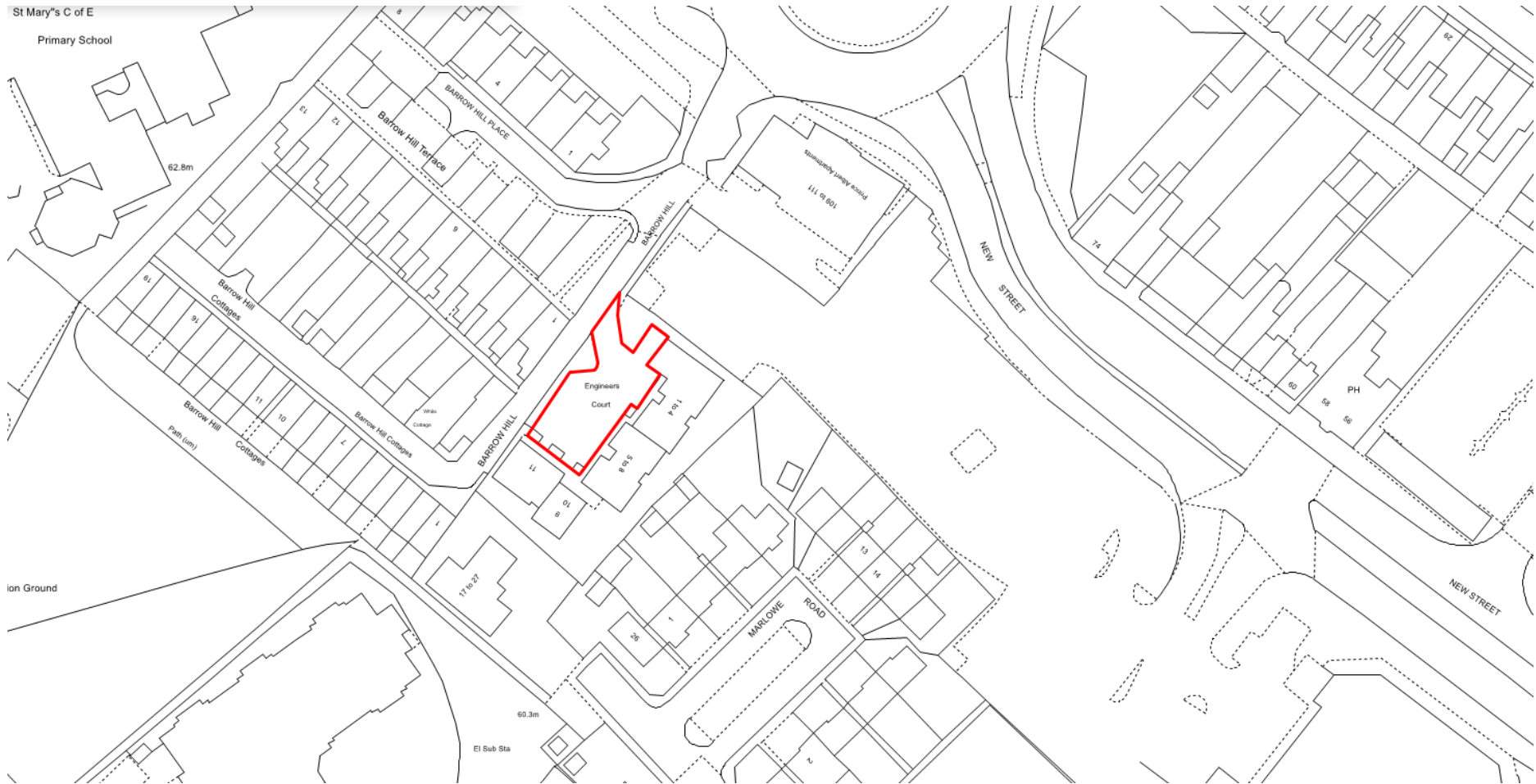

12. Fortis House

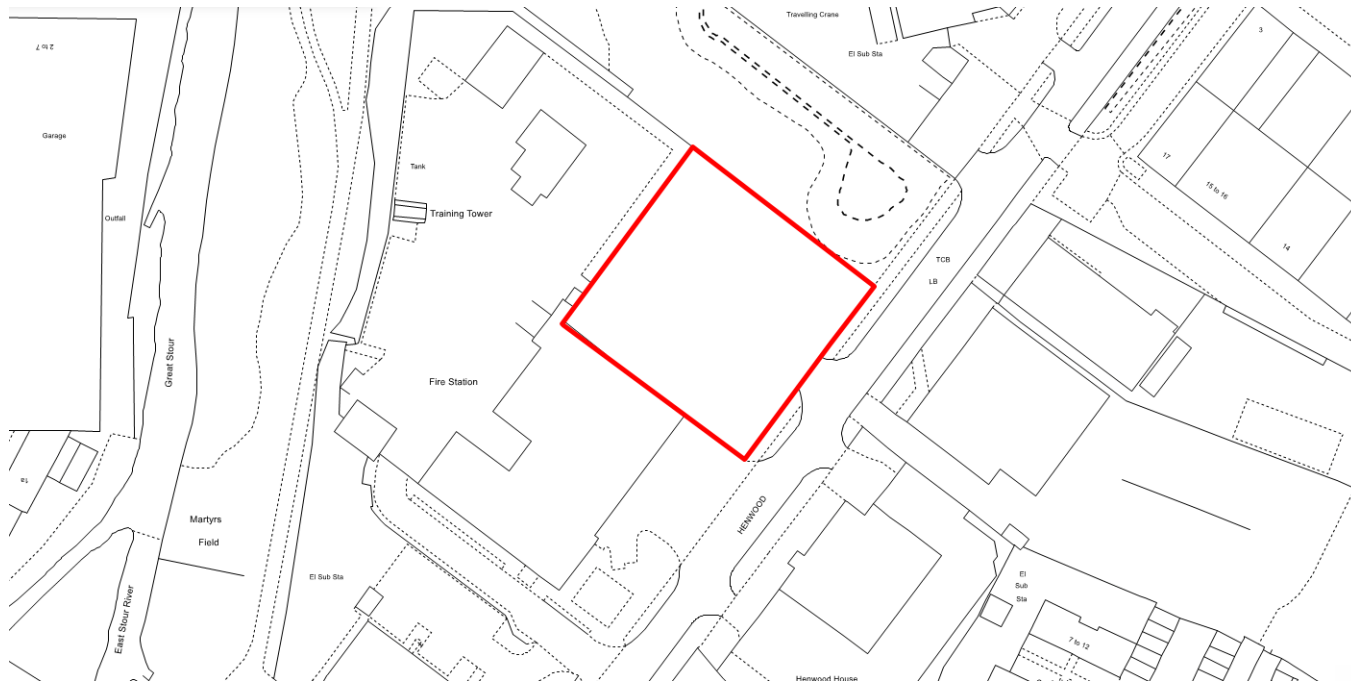

13. Forrester's Place Car Park



15. Marlowe Road Car Park

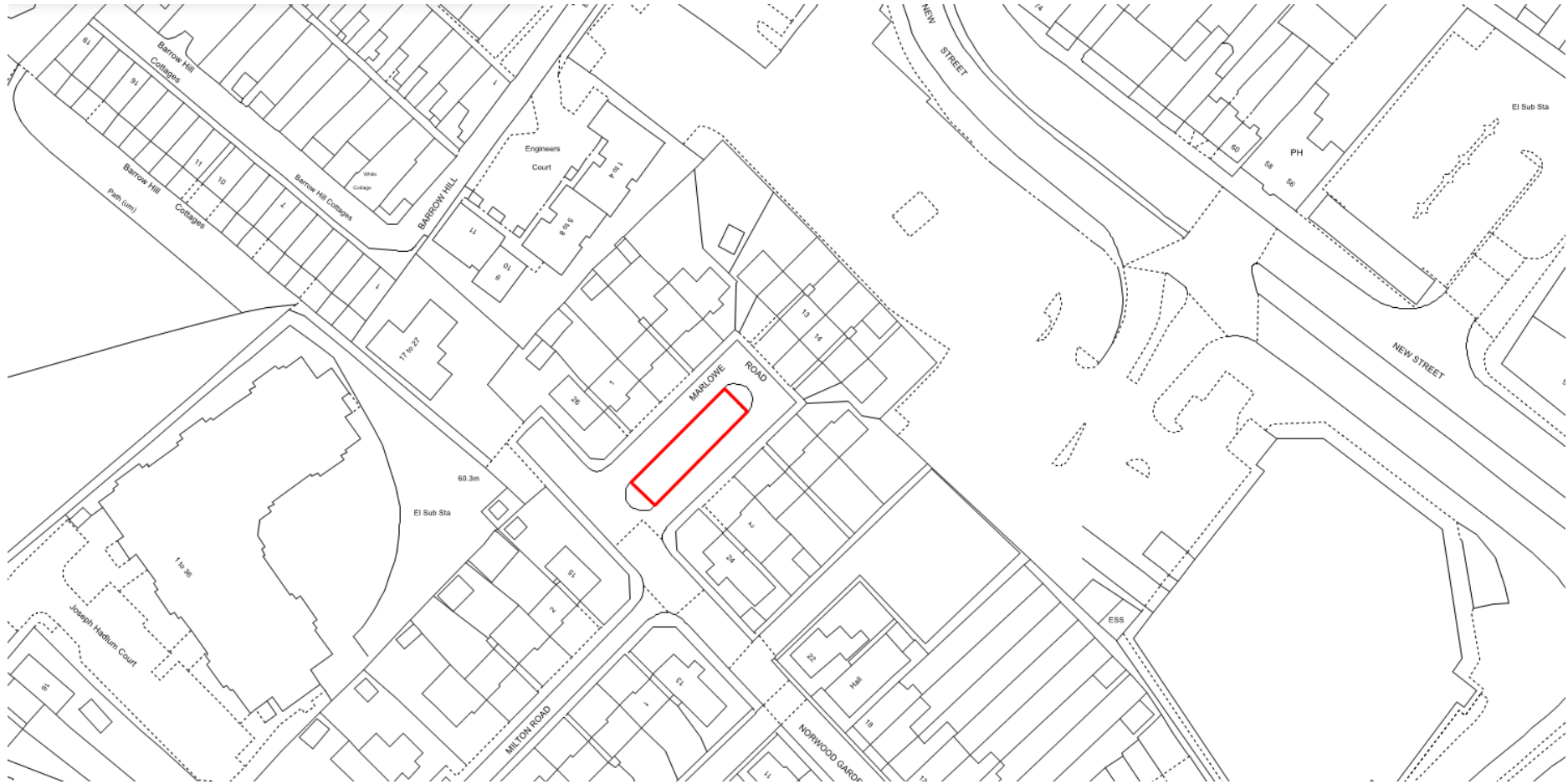

16. Maunsell Place Car Park

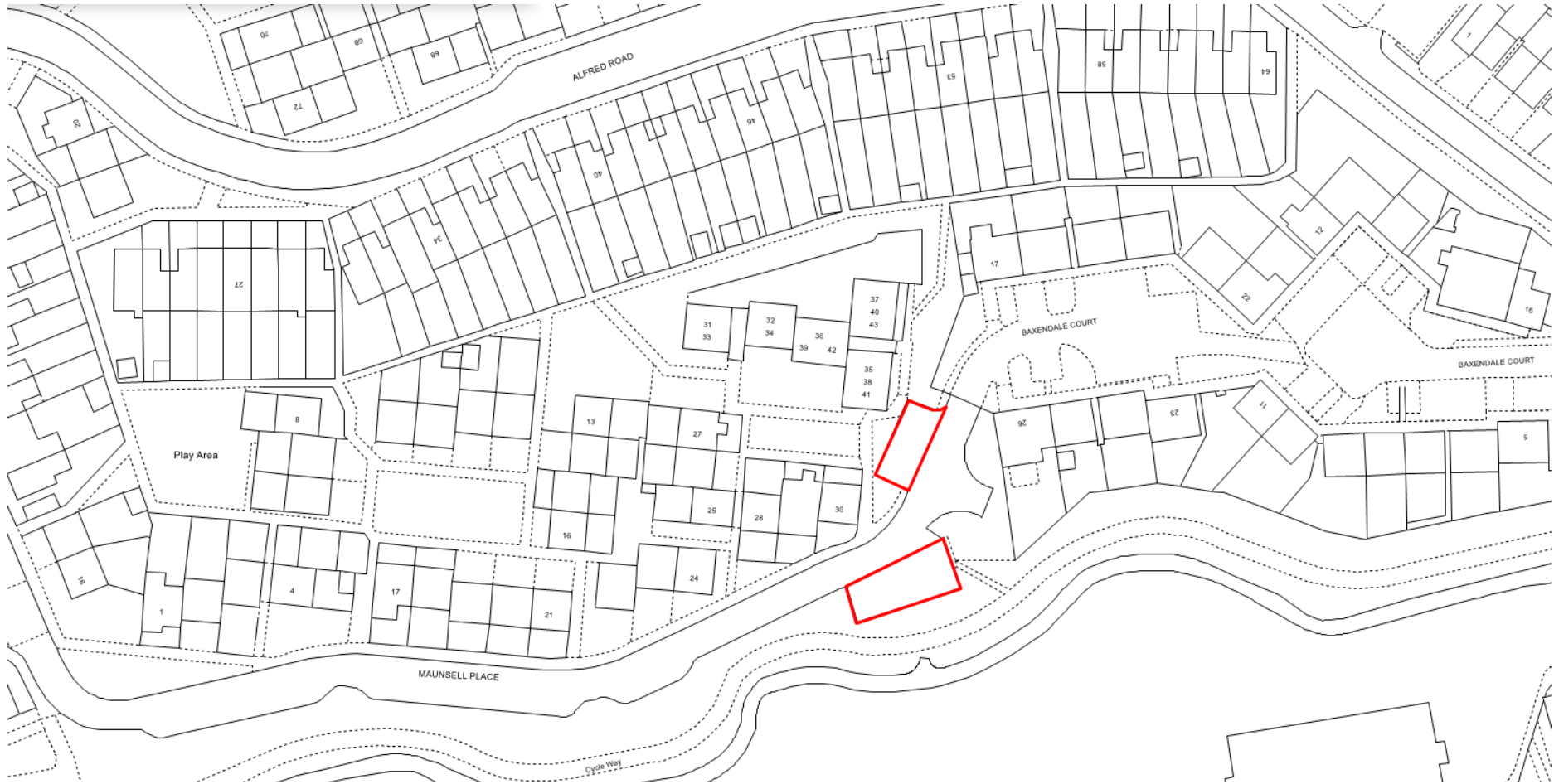

17. Newtown Green Car Park A

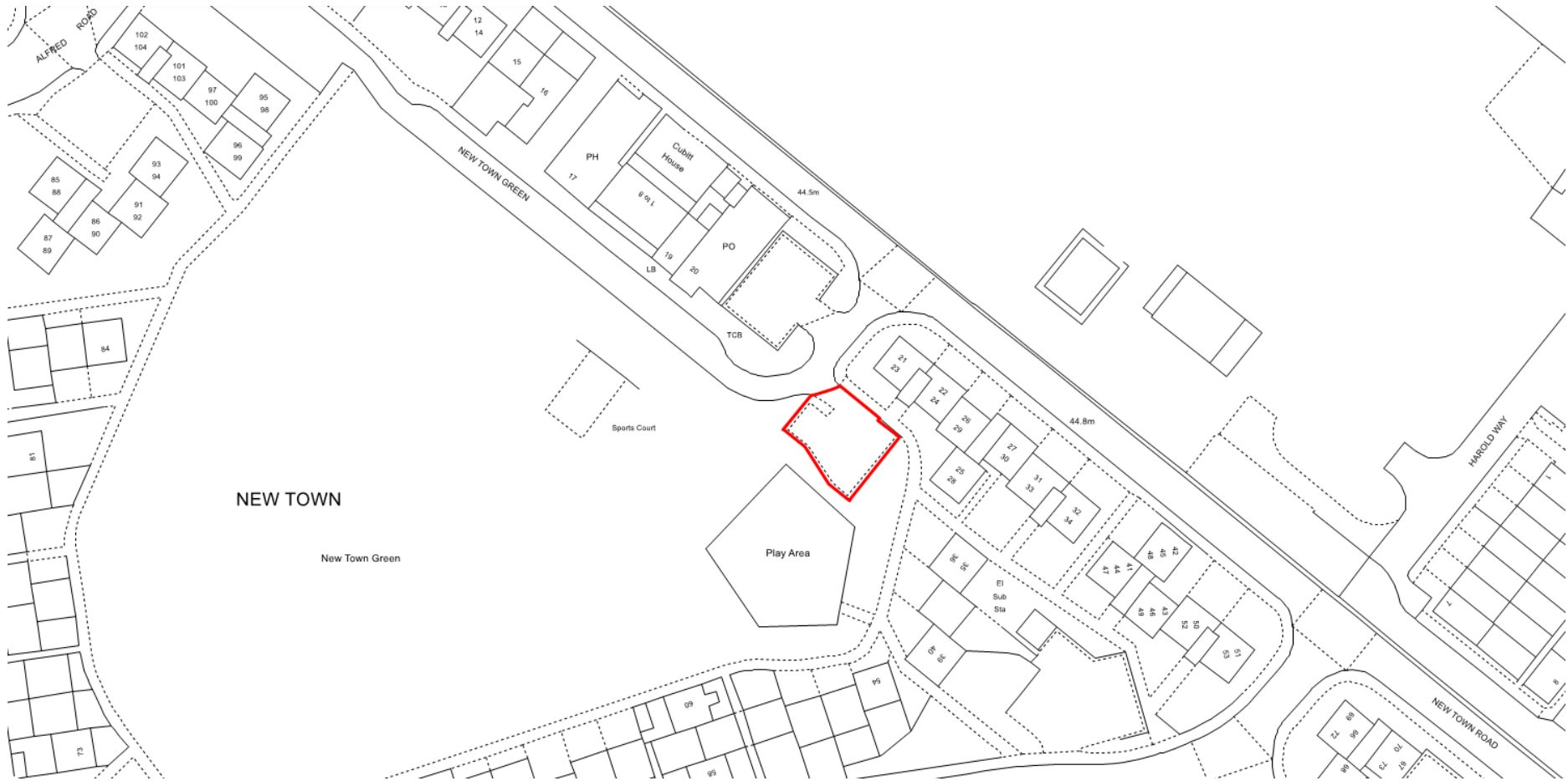

18. Newtown Green Car Park B

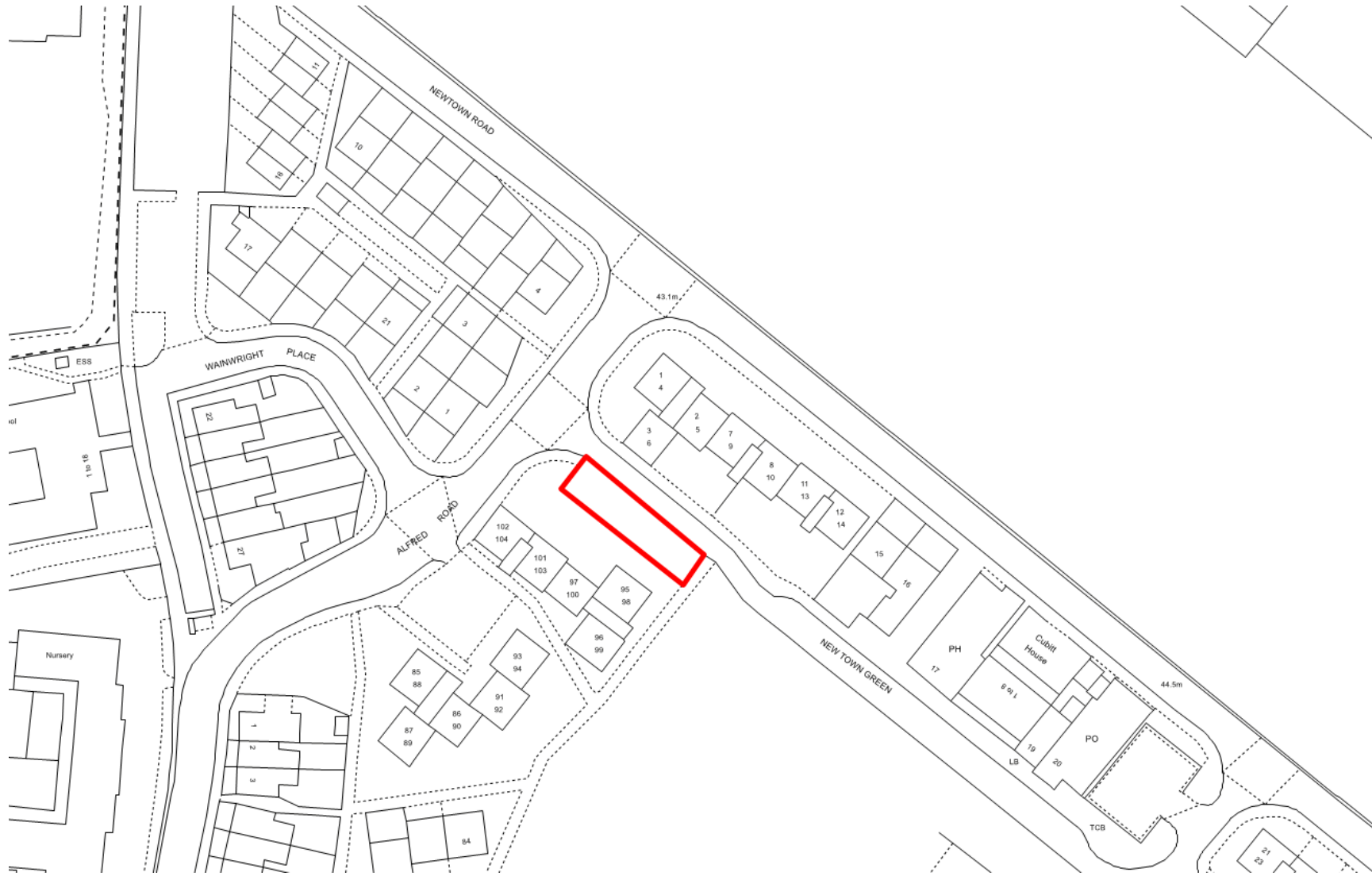

19. Norwood Gardens Car Park



20. Regents Court Car Park



21. Somerset Heights Car Park

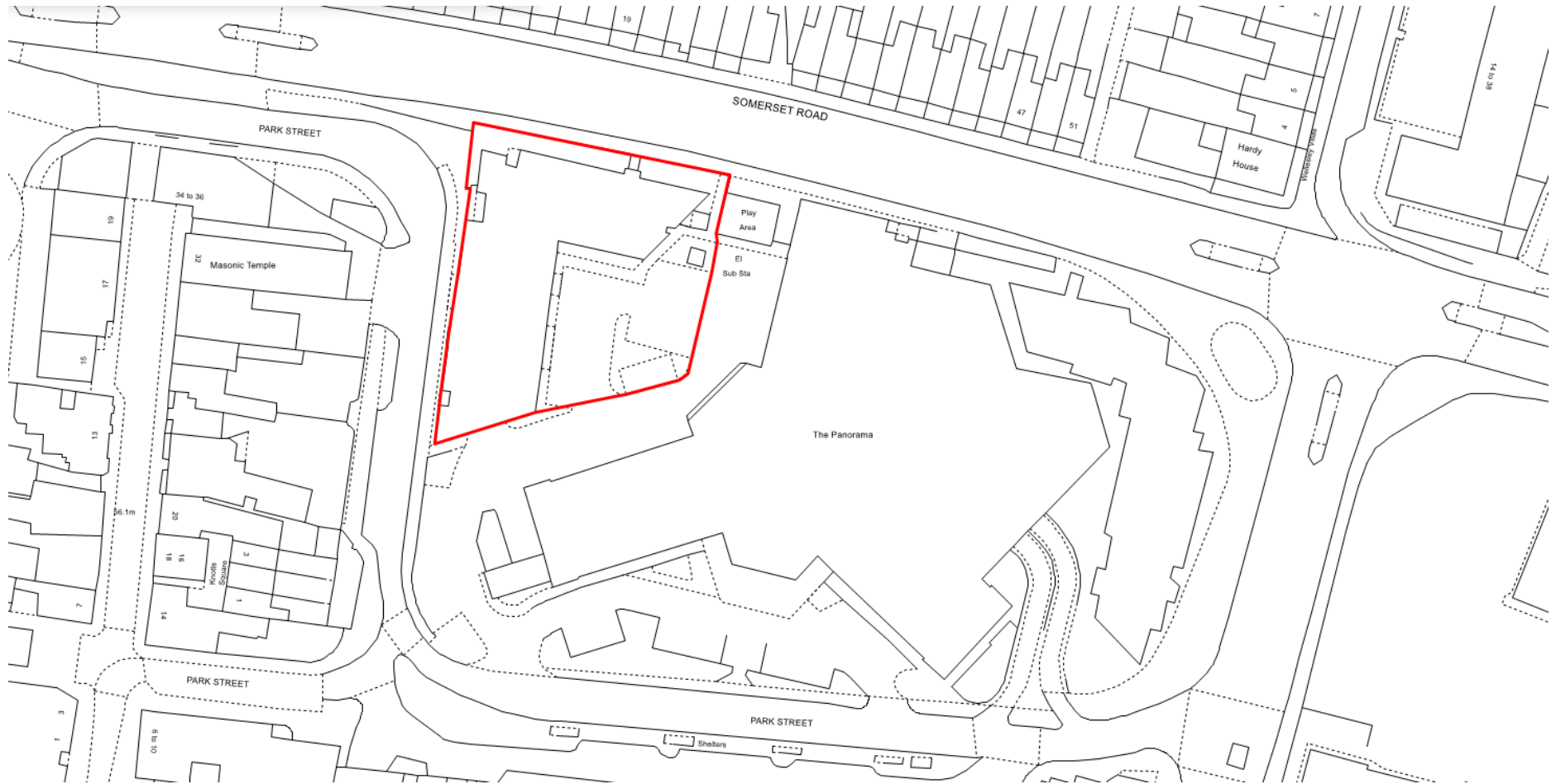

22. St Mildreds Close Car Park

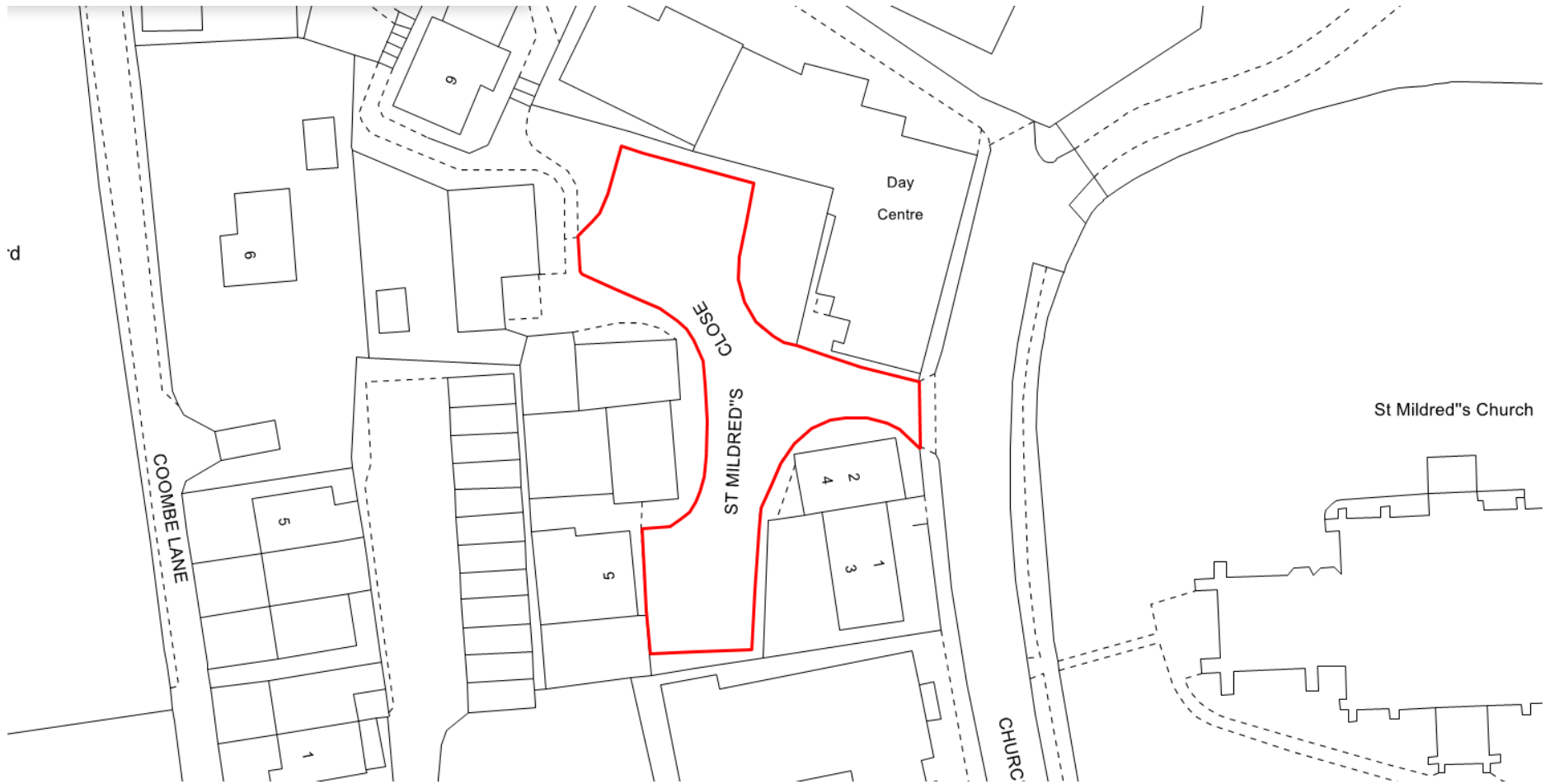

23. Stour Heights Car Park



(1) Stour Heights – Basement Level

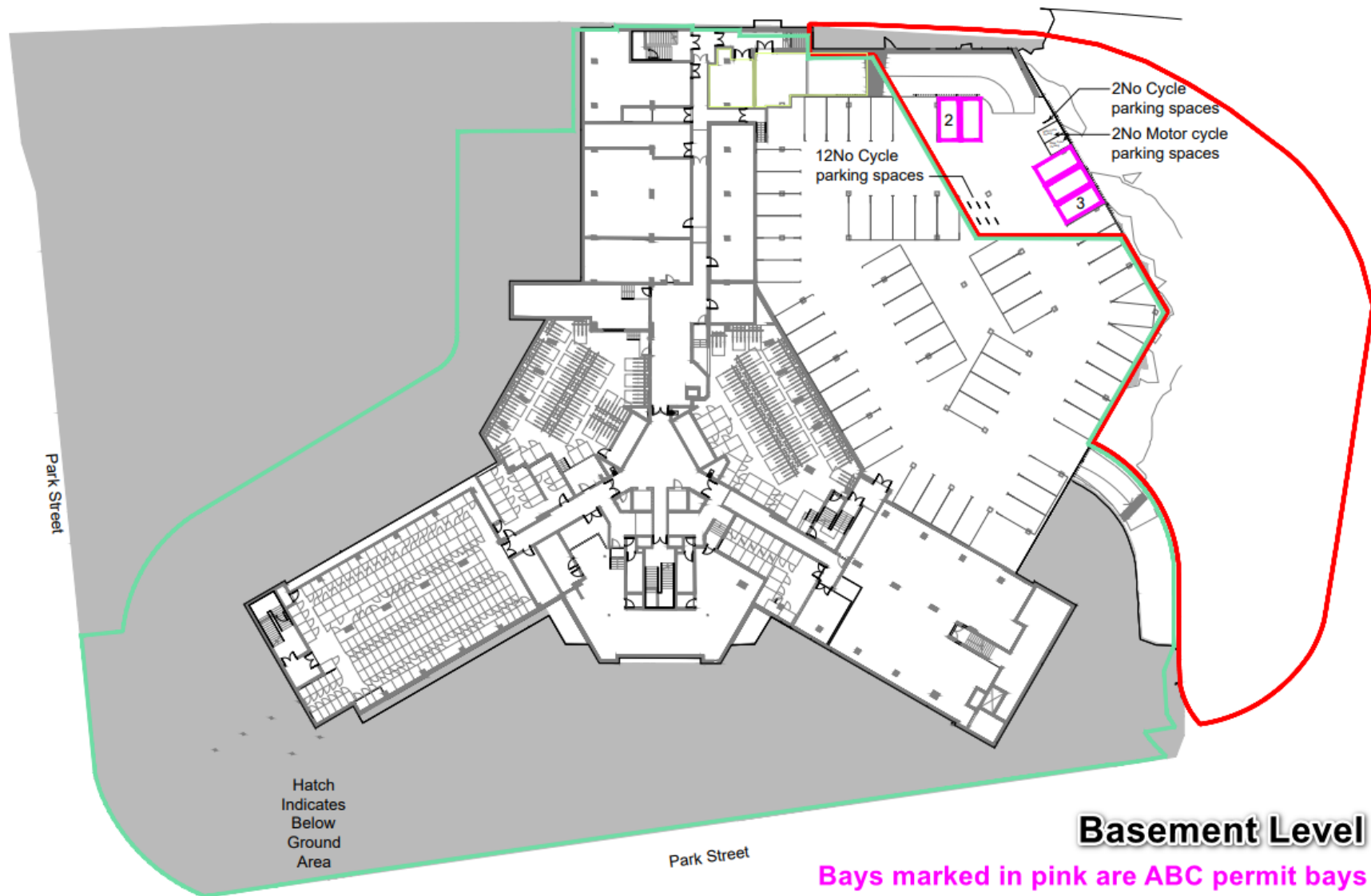

(2) Stour Heights – Mezzanine Level

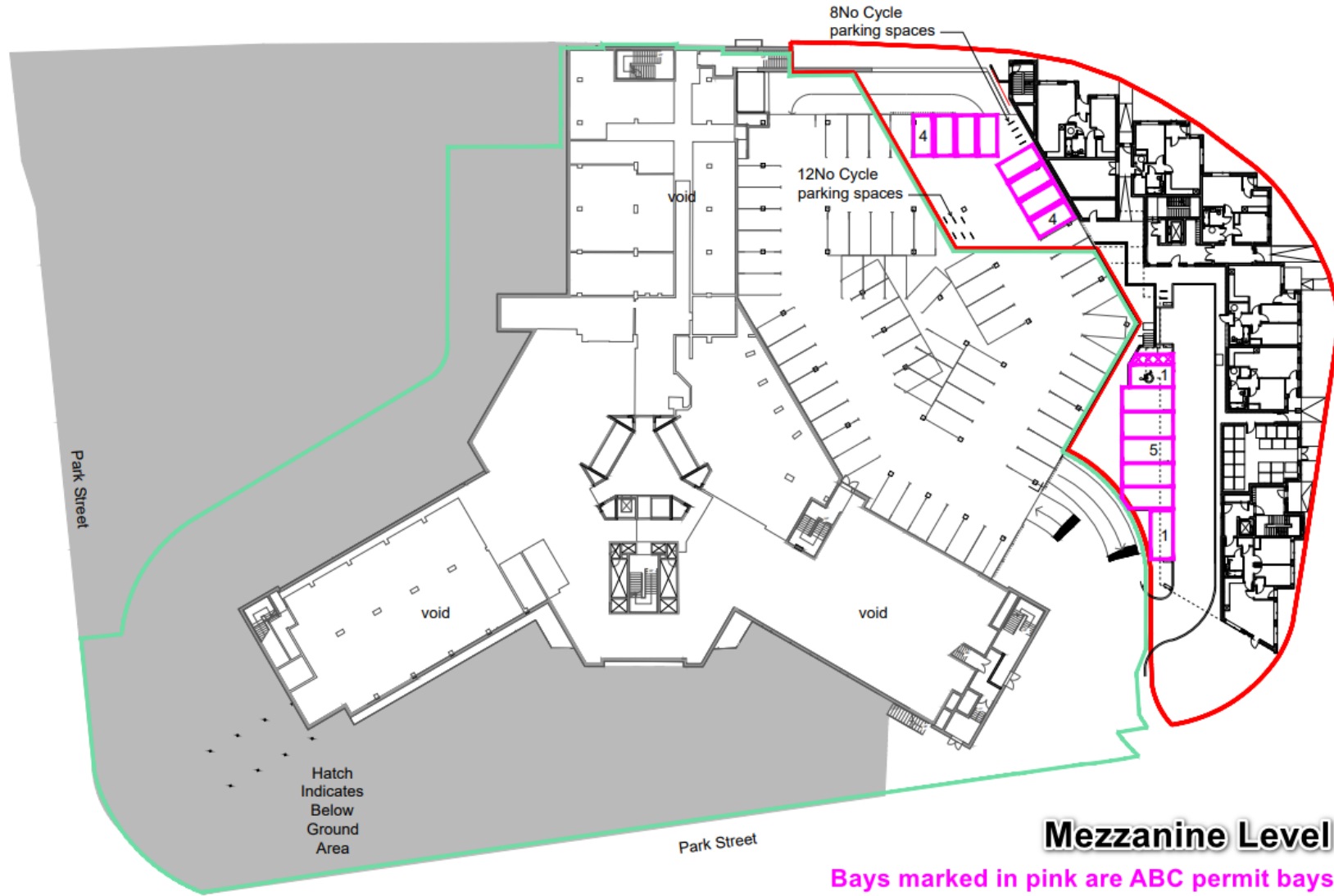

24. Wainwright Place Car Park

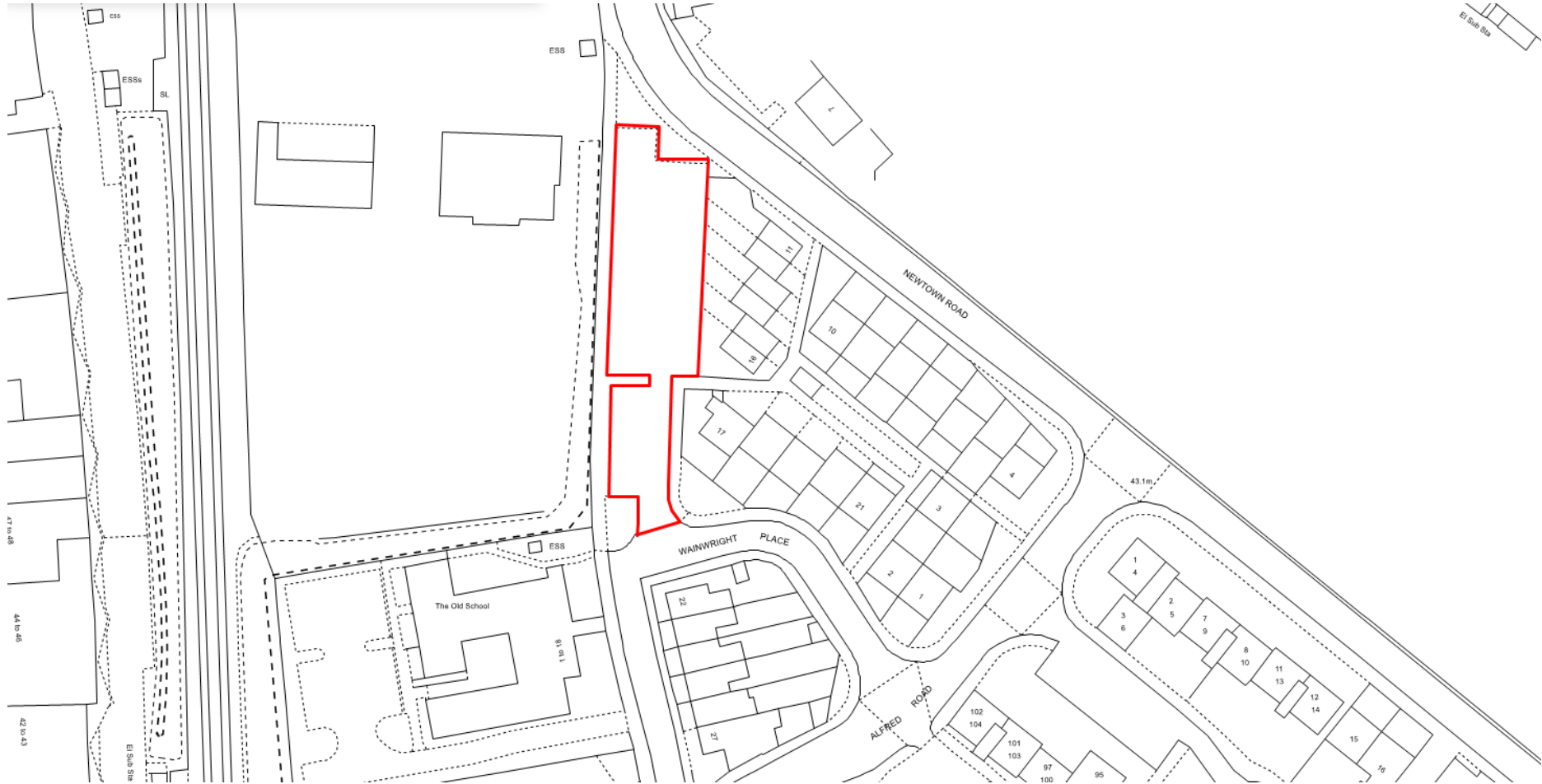

STATEMENT of REASON



ASHFORD
BOROUGH COUNCIL

In the Borough of Ashford
THE ASHFORD BOROUGH COUNCIL
HOUSING CAR PARK PLACES (PROHIBITION OF PARKING)
ORDER 2025

Road Traffic Regulation Act 1984

STATEMENT OF REASONS

Ashford Borough Council make the Order referred to above to above to create car parks for the use of Ashford Borough Council tenants as shown on the drawings accompanying this document;

For preventing damage to the road or to any building on or near the road

for preventing the use of the road by vehicular traffic of a kind which, or its use by vehicular traffic in a manner which, is unsuitable having regard to the existing character of the road or adjoining property

For preserving or improving the amenities of the area through which the road runs

Michael Fairlie
Technical & Transport Officer
Safety & Wellbeing

PUBLIC NOTICE



ASHFORD
BOROUGH COUNCIL

In the Borough of Ashford

THE ASHFORD BOROUGH COUNCIL HOUSING CAR PARK PLACES (PROHIBITION OF PARKING) ORDER 2025

Notice is hereby given that ASHFORD BOROUGH COUNCIL propose to make the above Order under section 35 of the Road Traffic Regulation Act 1984, having obtained the consent of the Kent County Council in accordance with Section 39(3) of the Act, and all other enabling powers, and after consultation with the chief officer of police in accordance with Part III of Schedule 9 of the Act

The effect of the order is to prohibit the parking of unauthorised vehicles within various car parks maintained by the Housing department at Ashford Borough Council. A permit will be required to park in all areas within the proposed Order.

A full statement of the Council's reasons for making the proposed Order, a plan indicating the locations and the effect and a copy of any other Orders which will be amended by the proposed Order may be examined online from **Friday 21 February 2025** at <https://www.ashford.gov.uk/housingcarparks>

General queries can be made at engineering@ashford.gov.uk using the reference **HOUSING**.

Representations supporting or objecting to the proposed Order (your objection must explain the impact on traffic in the locality to be valid) can be made via our website using the above link or alternatively you can write to Engineering Services, Ashford Borough Council, International House, Dover Place, Ashford, TN23 1HU by **midday on Friday 21st March 2025**.

T W Mortimer
Solicitor to the Council & Monitoring Officer