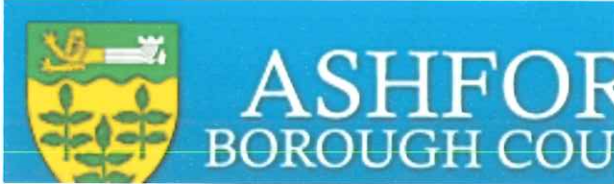

Community Nomination Form

FOR OFFICE USE ONLY

Reference Number	
Date of Validation	

 <p>ASHFORD BOROUGH COUNCIL</p> <p>ASSETS OF COMMUNITY VALUE</p> <p>COMMUNITY NOMINATION FORM</p>
--

Section A: About your organisation

A1 Organisation's name and address

Name of organisation Rolvenden Parish Council
Registered, main or head office address including postcode Wealden House, Grand Parade, Littlestone, Kent TN28 8NQ

A2 Contact details

Name Peter Setterfield
Position in organisation Parish Clerk & Responsible Financial Officer
Address including postcode Wealden House, Grand Parade, Littlestone, Kent TN28 8NQ
Daytime telephone no. 07714300986
Email address rolvendenclerk@gmail.com

A3 Type of organisation

Description (pursuant to Regulation 5)	Put a tick against that which applies	Registration number (if applicable)
(a) Designated Neighbourhood Forum pursuant to s.61F of the Town and Country Planning Act 1990		
(b) Parish Council	√	
(c) Unincorporated body with at least 21 members which does not distribute any surplus it makes to its members		
(d) Charity		
(e) Company limited by guarantee which does not distribute any surplus it makes to its members		
(f) Industrial and Provident Society which does not distribute any surplus it makes to its members		
(g) Community Interest Company		

A4 Local Connection (pursuant of Regulation 4)

Unless you are a Parish Council (see below), your organisation must have a local connection, which means that its activities are wholly or partly concerned with the administrative area of Ashford Borough Council or a neighbouring local authority (Reg 4(1)(a)). Please explain what your association's local connection is.

Local Parish Council

Please note the following in relation to Community Nominations from Parish Councils (Reg 5(b)) –

A Parish Council making a Community Nomination in respect of land in its parish does not need to show a local connection (s.89(2)(b)(i)).

A Parish Council making a Community Nomination in relation to land in another parish has a local connection if the two parishes share a common boundary at any point. (Reg 4(2)(a)).

A Parish Council making a Community Nomination in relation to land which is not within a parish has a local connection if the parish is in the borough of Ashford or (if the parish council is outside the borough, it shares a common boundary with the borough of Ashford) (Reg 4(2)(b)).

(If you ticked (c) at Q.A3 please fill out the next question)

A5 Membership of Unincorporated Bodies (Reg 5 (c) (pursuant to Regulation 4(1)(c) and Reg 4(3))

In the case of an unincorporated body at least 21 of its members must be registered to vote in local government elections in the borough of Ashford or in a neighbouring authority's area. Please include a list of the current members of the body and their addresses. If they are registered to vote in the area of a neighbouring local authority, rather than in Ashford, please confirm which area this is.

(if you ticked (c), (e) or (f) in Q.A3 please answer the question below)
A6 Distribution of surplus funds (Unincorporated Bodies (Reg 5(1)(c)), companies limited by guarantee (Reg 5(1)(e)) and Industrial and Provident Societies (IReg 5(1)(f) (pursuant to Reg 4(b)))

If your organisation is an Unincorporated Body, a Company Limited by Guarantee, or an Industrial and Provident Society then any surplus that it makes must be wholly or partly applied for the benefit of the administrative area of Ashford or a neighbouring local authority. Please confirm this and provide evidence by referring to the relevant part of the document provided pursuant to part A7.

A7 Required Documentation for your organisation (not required if a Parish Council)

Please provide us with an up-to-date copy of the following as relevant to your organisation	Please put a tick against the document provided
Memorandum and Articles of Association	
Trust Deed	
Constitution	
Interest Statement if a Community Interest Company	
Companies House Return	
List of Members	
Minute / authority authorising your organisation to make this Community Nomination	

Part B: Information concerning the land / building(s) which is subject to the Community Nomination

B1 Description and address

Name of land / building(s) Rolvenden Working Mens Club
Address including postcode Maytham Road, Rolvenden, Cranbrook, Kent TN17 4NE

*please note that we can only accept nominations for land within the borough of Ashford. If the land you wish to nominate is partly in and partly outside of the borough, then you should nominate that part which is outside of the borough to the appropriate local council in whose are it falls

B2 Detailed plan

Please include (here or on a separate sheet) a detailed plan of the land.

The plan must:

- be drawn to scale
- be a copy of an extract from the Ordnance Survey map on the largest scale published (generally 1/1250 for urban properties and 1/2500 for rural properties), showing the land to which the application relates
- indicate the scale and orientation
- show the precise extent of the property by suitable edging (0.4mm max), and
- show the position of the land in relation to nearby roads and other relevant features.

Plan attached

*Please note that by submitting the plan, you authorise us to copy and publish as may be necessary

B3 Owners and others with an interest in the land / building(s) (Reg 8)

Please provide the following information to the best that you are able. If any information is not known to you, please say so.

	Name(s)	Address(es)
Names of all current occupants of the land / building(s) (if there are different occupiers for different parts please provide details)	The Trustees of Rolvenden Club	The Club House, Rolvenden Club, Maytham Road, Rolvenden, Cranbrook, Kent TN17 4NE
Names and current or last known addresses of all those owning a freehold interest in the land / buildings (s)	The Trustees of Rolvenden Club	The Club House, Rolvenden Club, Maytham Road, Rolvenden, Cranbrook, Kent TN17 4NE
Names and current or last known addresses of all those owning a leasehold interest in the land / building(s)		

Please answer wither B4 or B5 below -

B4 For Land / building(s) currently in use for community benefit – why you think the land / building(s) is of community value

1. What is the current main use of the land / building(s)
The current use of the building is a club house with alcohol licence that is also used for christenings, wedding receptions and funeral wakes. The land to the roadside is utilised as a car park to the club.

2. How does that current main use of the land / building(s) further the social wellbeing or social interests of the local community (defined in s.88(6) of the Act)
The current use of the building provides an alternative venue to the Village Hall with the additional benefit of an alcohol licence with ample parking on site.

3. Why do you consider that this, or some other main use to which the land / building(s) will be put which will further the social wellbeing or social interests of the local community, will continue and over what period (defined in s.88(6) of the Act)
The club and its associated land are situated within the historic Great Maytham Park, registered parkland number 1000221, and are designated within the Rolvenden Neighbourhood Plan as community assets. It would be in the social wellbeing and interests of the local community to retain the venue for use as an alternative to the village hall. The land currently is subject to restrictive covenants as to its usage.

B5 For Land / building(s) not currently in use for community benefit (s.88 (2) of the act)

Please answer the questions below

1. If the land / building(s) main use in the recent past furthered the social wellbeing or social interests of the local community please confirm that use and explain how it did that (including dates for when this was) (defined in s.88(6) of the Act)

N/A

2. How do you anticipate that the land / building(s) will be returned to that use or put to some other main use which will further the social wellbeing or social interests of the local community and when do you consider this will happen

N/A

Section C: Submitting this nomination

C1 Signature

By signing your name here you are confirming that the contents of this form and the documents enclosed are correct, to the best of your knowledge and belief.

I am duly authorised to sign on behalf of the nominating organisation -

Signature

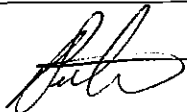

C2 Where to send this form

You can submit this Community Nomination Form:-

By post to:

Legal and Democratic Services
Ashford Borough Council
Civic Centre
Tannery Lane
Ashford
TN23 1PL

If any further information is required the Council will contact you by writing to you or emailing you at the contact details you have provided in the Nomination Form

Any Reference to "Regulation" or "Reg" is to the Assets of Community Value (England) Regulations 2012 and any reference to the "Act" is to the Localism Act 2011

H.M. LAND REGISTRY		TITLE NUMBER	
		K368311	
ORDNANCE SURVEY PLAN REFERENCE	COUNTY	SHEET	NATIONAL GRID
	KENT		TQ 843I
Scale: 1/1250 Enlarged from 1 2500			© Crown copyright 1971

ROLVENDEN PARISH

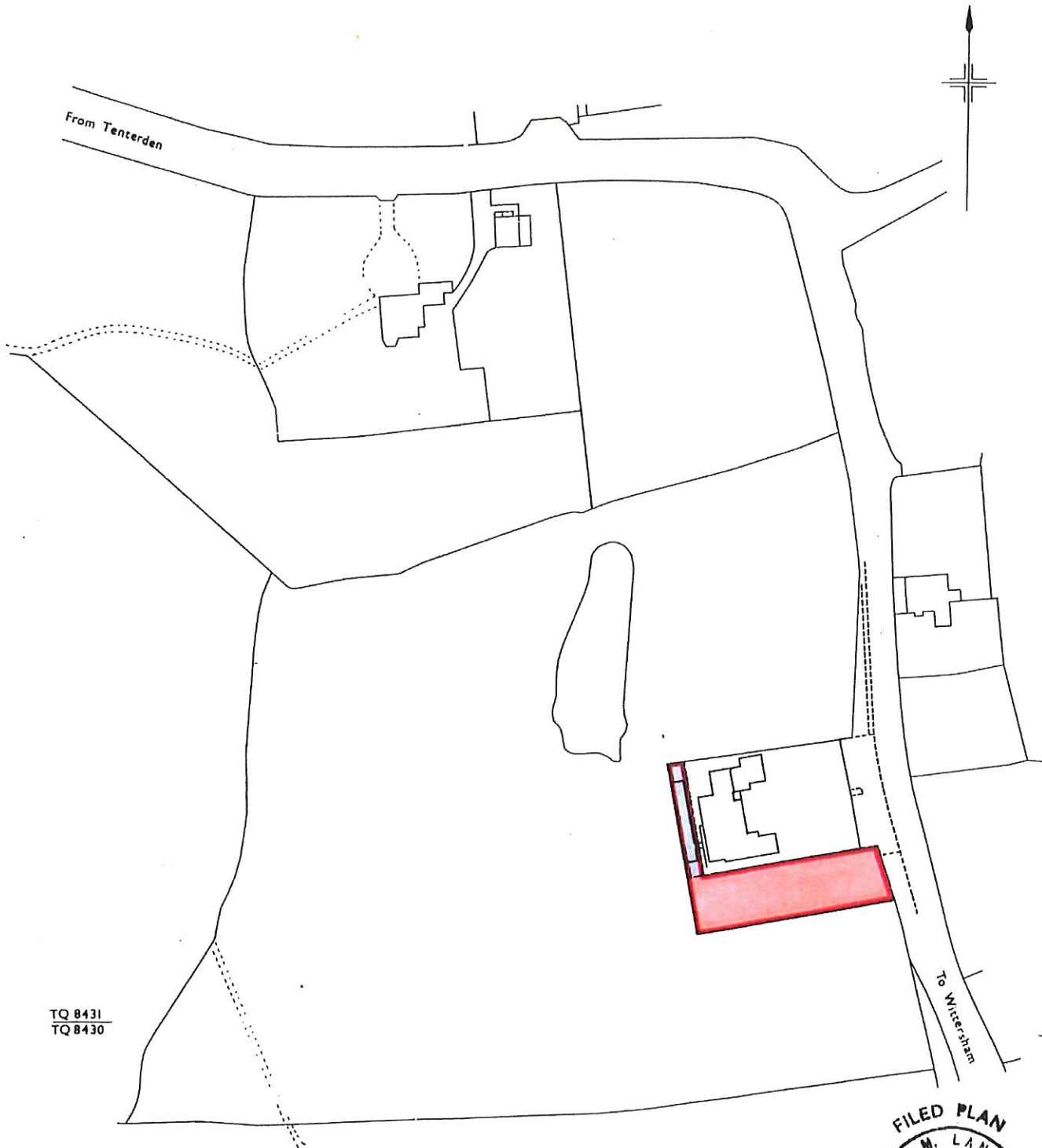

TQ 843I
TQ 8430



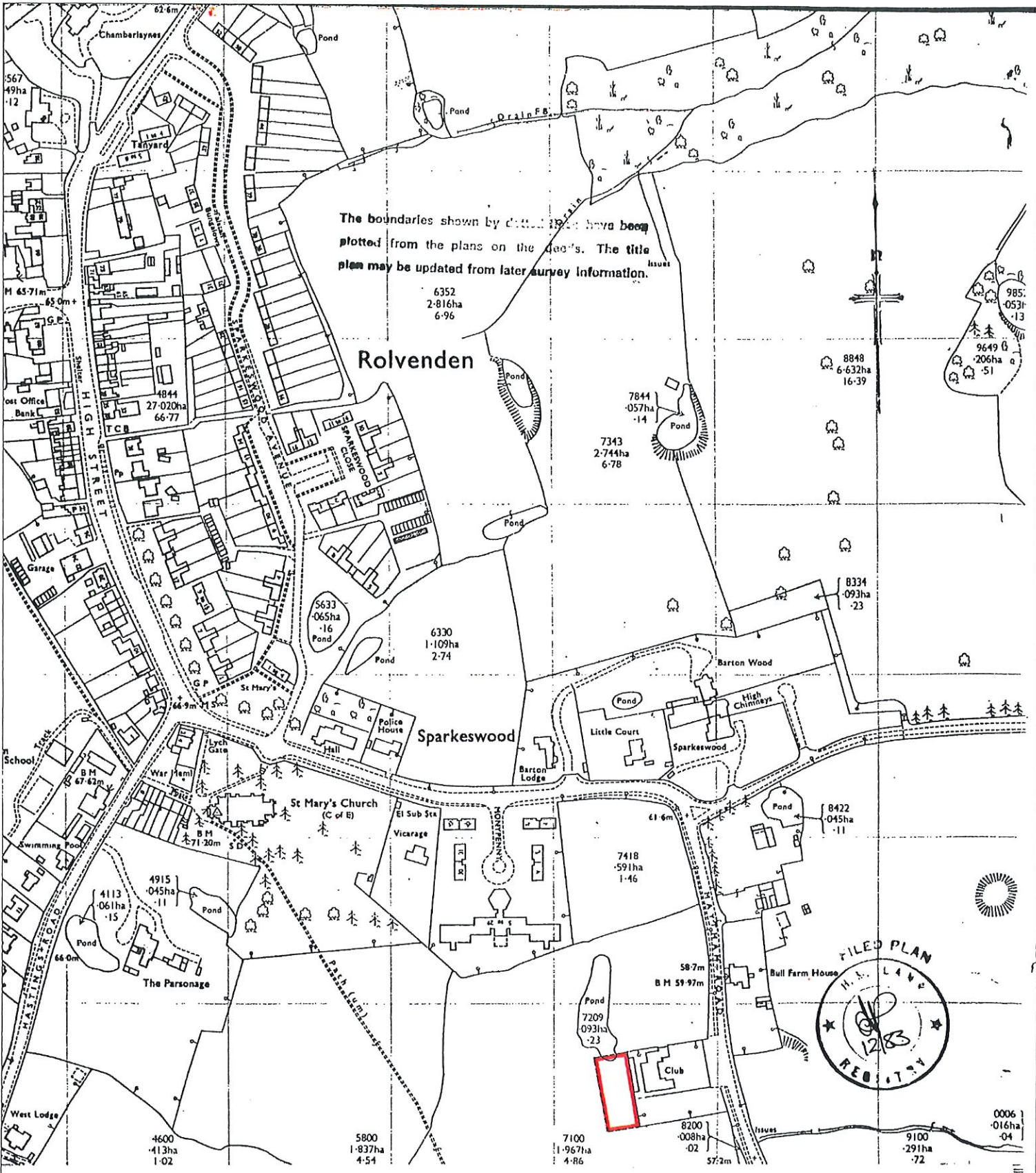

The boundaries shown by dotted lines have been plotted from the plans on the deeds. The title plan may be updated from later survey information.



H.M. LAND REGISTRY		TITLE NUMBER	
		K560143	
ORDNANCE SURVEY PLAN REFERENCE	TQ 8431	Scale 1/2500	
COUNTY KENT	DISTRICT ASHFORD	© Crown copyright	